

THREADED

Riley Blake
DESIGNS®

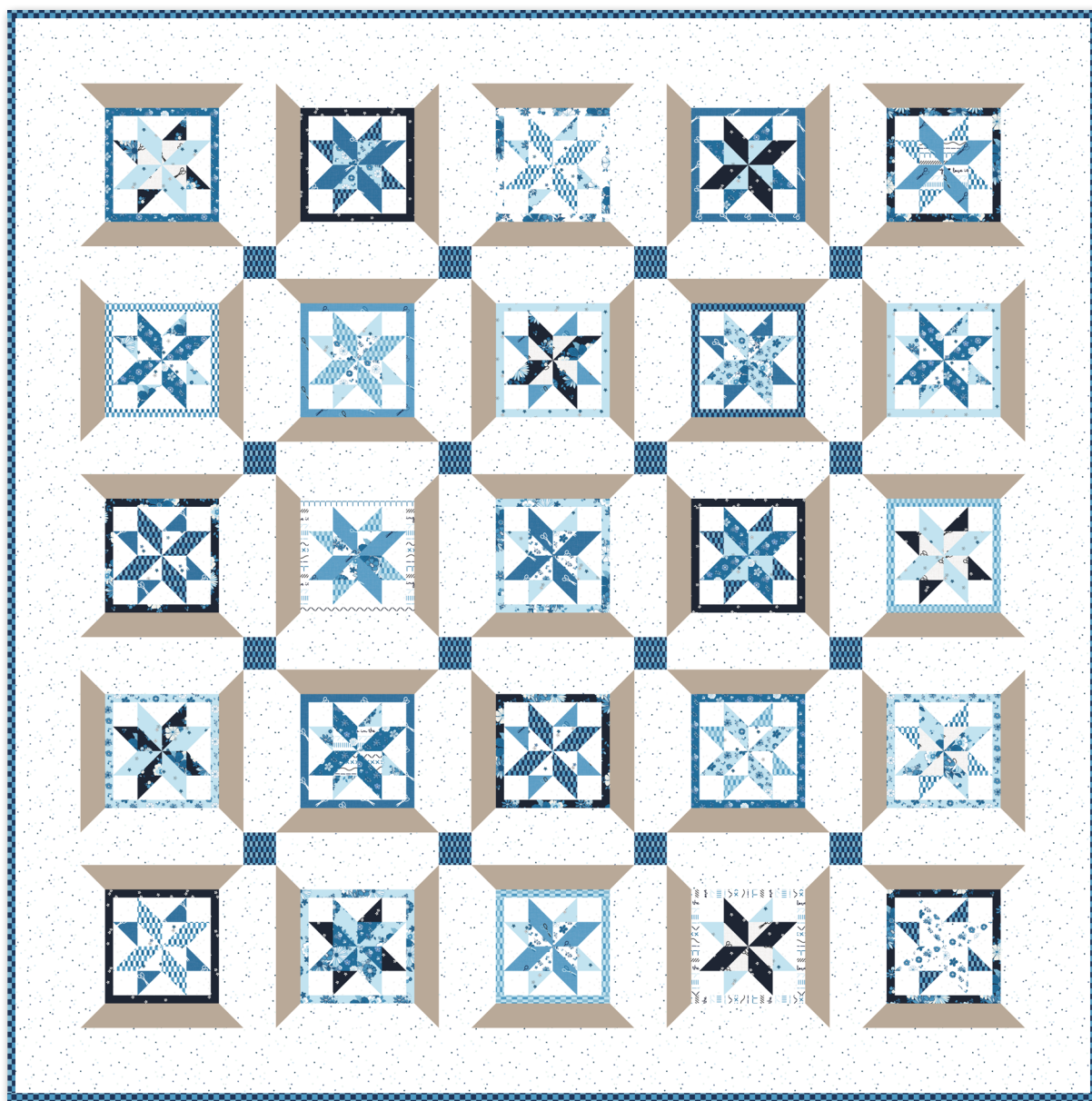

66 ½" x 66 ½"

blue blooms and threads
christopher thompson of the tattooed quilter



= Confident Beginner

01/01/2026

THREADED

FINISHED QUILT SIZE 66 ½" × 66 ½"

Please read all instructions before beginning this project.
Yardage calculated using a 42" usable width of fabric.

Pattern designed by Christopher Thompson.

GENERAL INSTRUCTIONS

Please check www.rileyblakedesigns.com/pattern-updates or scan the QR Code for any revisions before starting this project.

This pattern requires a basic knowledge of quilting techniques and terminology. The quilt and block diagrams portrayed are virtual images. The layout and look of your project may differ when using actual fabric. It is not recommended to prewash fabric before cutting and assembling.



WOF = Width of Fabric
RST = Right Sides Together
SNF = Stitch and Flip
SNF-FG = Stitch and Flip Flying Geese
HST = Half Square Triangle

FABRIC REQUIREMENTS

Fabric is from the Blue Blooms and Threads collection unless stated otherwise.

(1) 10-17120-42 10" Stacker

⅔ Yard of Each:

C120-BEACH Confetti Cotton™ Solid
C725-WHITE Blossom Tone-on-Tone



Additional Fabrics:

2 ½ yards C730-BLUECAROLINA Blossom on White
⅓ yard C17123-NAVY Checks (includes binding)

OTHER SUPPLIES

Basic Sewing Supplies
2 ½ yards WB6422-BLUE Plaid Bee Backing (wide back backing)
Batting

CUTTING INSTRUCTIONS

When cutting fabrics, use a straight edge ruler and rotary cutter. Measurements include ¼" seam allowance. Label, allocate, and organize all cuts as noted.

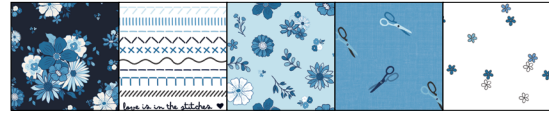

10" Stacker

Cut (25) matching sets of:

(2) 2 ½" × 2 ½" squares. Label as A.

(4) 2" × 2" squares. Label as B.

Cut (25) matching sets of:

(2) 2 ½" × 2 ½" squares. Label as C.

Cut (25) matching sets of:

(4) 2" × 2" squares. Label as D.

Cut (25) matching sets of:

(2) 1" × 7 ½" rectangles. Label as E.

(2) 1" × 6 ½" rectangles. Label as F.



Beach Confetti Cotton™ Solid

Cut (13) 2" × WOF strips. Subcut:

(50) 2" × 10 ½" rectangles. Label as G.



White Blossom

Cut (13) 2" × WOF strips. Subcut:

(100) 2" × 3 ½" rectangles. Label as H.

(100) 2" × 2" squares. Label as I.

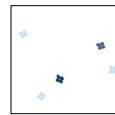

Blue Carolina Blossom

Cut (6) 4 ½" × WOF strips. Piece together end-to-end; subcut:

(2) 4 ½" × 66 ½" strips. Label as J.

(2) 4 ½" × 58 ½" strips. Label as K.

Cut (10) 2 ½" × WOF strips. Subcut:

(40) 2 ½" × 10 ½" rectangles. Label as L.

Cut (15) 2" × WOF strips. Subcut:

(50) 2" × 7 ½" rectangles. Label as M.

(100) 2" × 2" squares. Label as N.



Navy Checks

Cut (8) 2 ½" × WOF strips. Set (7) strips aside for binding. From the remaining strip, cut:

(16) 2 ½" × 2 ½" squares. Label as O.

SEWING TECHNIQUES

Sew all seams RST and with a $\frac{1}{4}$ " seam allowance unless stated otherwise. Refer to the Quilt Layout Diagram for placement of the fabrics. Press seams as desired unless stated otherwise. Dimensions listed in steps are unfinished sizes. Please refer to the following general sewing techniques as these methods are referenced throughout the pattern in their abbreviated form.

STITCH AND FLIP METHOD (SNF)

Place (2) pieces RST, matching raw edges in the corner to be replaced. Draw a diagonal line on the wrong side of the smaller piece across the corner. Sew on the drawn line. Trim the seam allowance outside the sewn line to $\frac{1}{4}$ ". Flip the smaller piece away from the larger piece and press, replacing the corner. The size of the larger, original piece does not change.

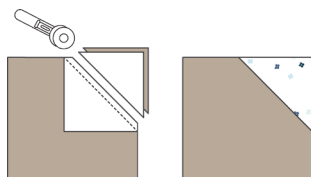

STITCH AND FLIP FLYING GEESE METHOD (SNF-FG)

Draw a diagonal line, corner to corner, on the wrong side of (2) squares. Place (1) square in a corner of (1) rectangle, RST, matching raw edges in the corner to be replaced. Sew on the drawn line. Trim the seam allowance outside the sewn line to $\frac{1}{4}$ ". Flip the square away from the rectangle and press, replacing the corner. Repeat with the second square in the opposite corner. The size of the original rectangle does not change.

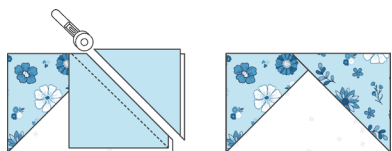

2-AT-A-TIME HALF SQUARE TRIANGLE METHOD (HST)

Place (2) squares RST. Draw a diagonal line on the wrong side of (1) square. Sew $\frac{1}{4}$ " on each side of the drawn line. Cut on the drawn line to create (2) HSTs. Press toward the darker fabric. Trim HSTs to the indicated size.

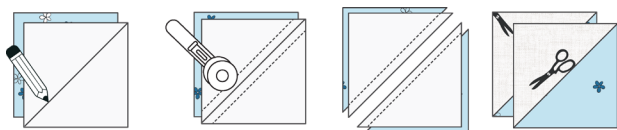

BLOCK ASSEMBLY

1. Gather (1) matching set of **A**- and **B**-squares, (1) matching set of **C**-squares, (1) matching set of **D**-squares, and (1) matching set of **E**- and **F**-rectangles. Also gather (4) **H**-rectangles and (4) **I**-squares.
2. Use the SNF-FG method to sew (1) **B**-square to the bottom-left corner and (1) **D**-square to the bottom-right corner of (1) **H**-rectangle as shown below. Repeat to make (4) matching SNF-FG units.

Make (4)

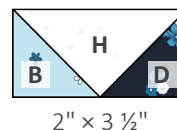

3. Use the 2-at-a-time HST method using **A**-squares and **C**-squares to make (4) total HST units as shown below.

Make (4)

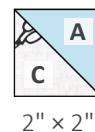

4. Arrange (4) HST units as shown below, paying careful attention to orientation. Sew the units together into pairs. Next, sew the pairs together to make (1) Pinwheel Unit.

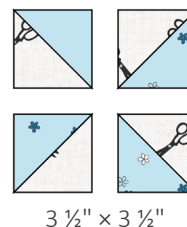

5. Arrange (4) **I**-squares, (4) SNF-FG units, and (1) Pinwheel Unit as shown below. Sew the squares and units together into rows. Next, sew the rows together to make (1) Star Unit.

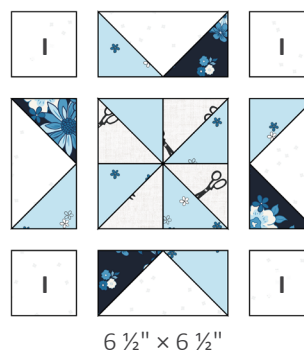

THREADED

- Sew (1) **F**-rectangle to each side of (1) Star Unit as shown below. Next, sew (1) **E**-rectangle to the top and bottom to make (1) Spool Center Unit.
- Repeat steps 1-6 to make (25) total Spool Center Units.

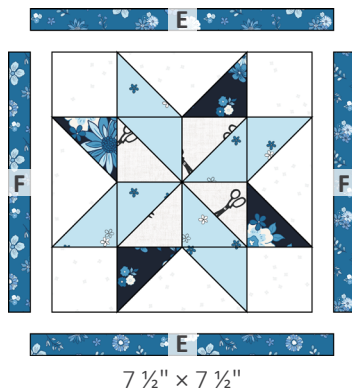

- Use the SNF method to sew (1) **N**-square to each bottom corner of (1) **G**-rectangle as shown below to make (1) Spool End Unit. Repeat to make (50) total units.

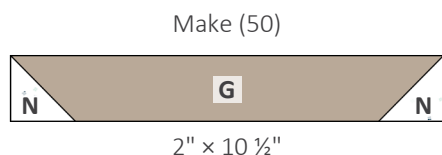

- Sew (1) **M**-rectangle to each side of (1) Spool Center Unit as shown below. Next, sew (1) Spool End Unit to the top and bottom, rotating units as shown, to make (1) Spool Block. Repeat to make (25) total blocks.

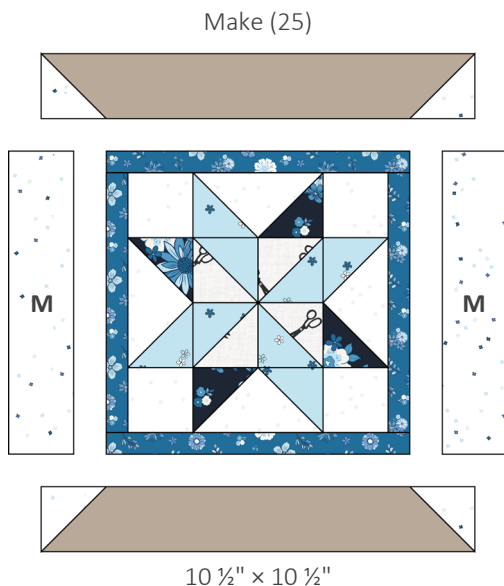

QUILT ASSEMBLY

- Arrange (25) Spool Blocks, (40) **L**-rectangles, and (16) **O**-squares as shown in the Quilt Layout Diagram on page 5, rotating blocks as shown. Sew the blocks and pieces together into rows. Next, sew the rows together to make the quilt center.
- Sew (1) **K**-strip to each side of the quilt center as shown below. Next, sew (1) **J**-strip to the top and bottom to complete the quilt top.

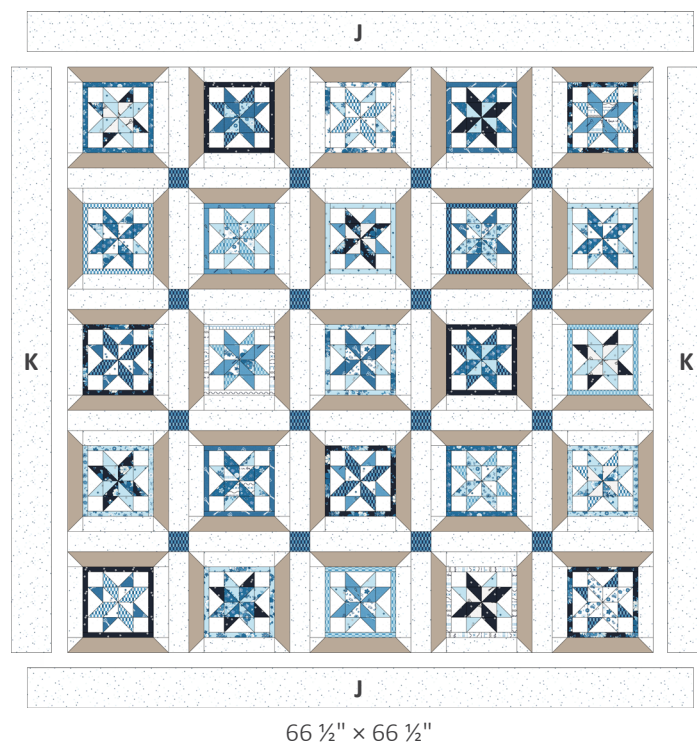

FINISHING INSTRUCTIONS

- Layer the quilt top, batting, and backing. Baste the quilt layers together and quilt as desired. Sew the Navy Checks binding strips together end-to-end. Then bind the trimmed, finished quilt using your favorite binding method.

Enjoy and share your quilt using the hashtags:
[#bluebloomsandthreadsfabric](#), [#threadedquilt](#),
[#rileyblakedesigns](#), and [#iloverileyblake](#).

THREADED

QUILT LAYOUT DIAGRAM

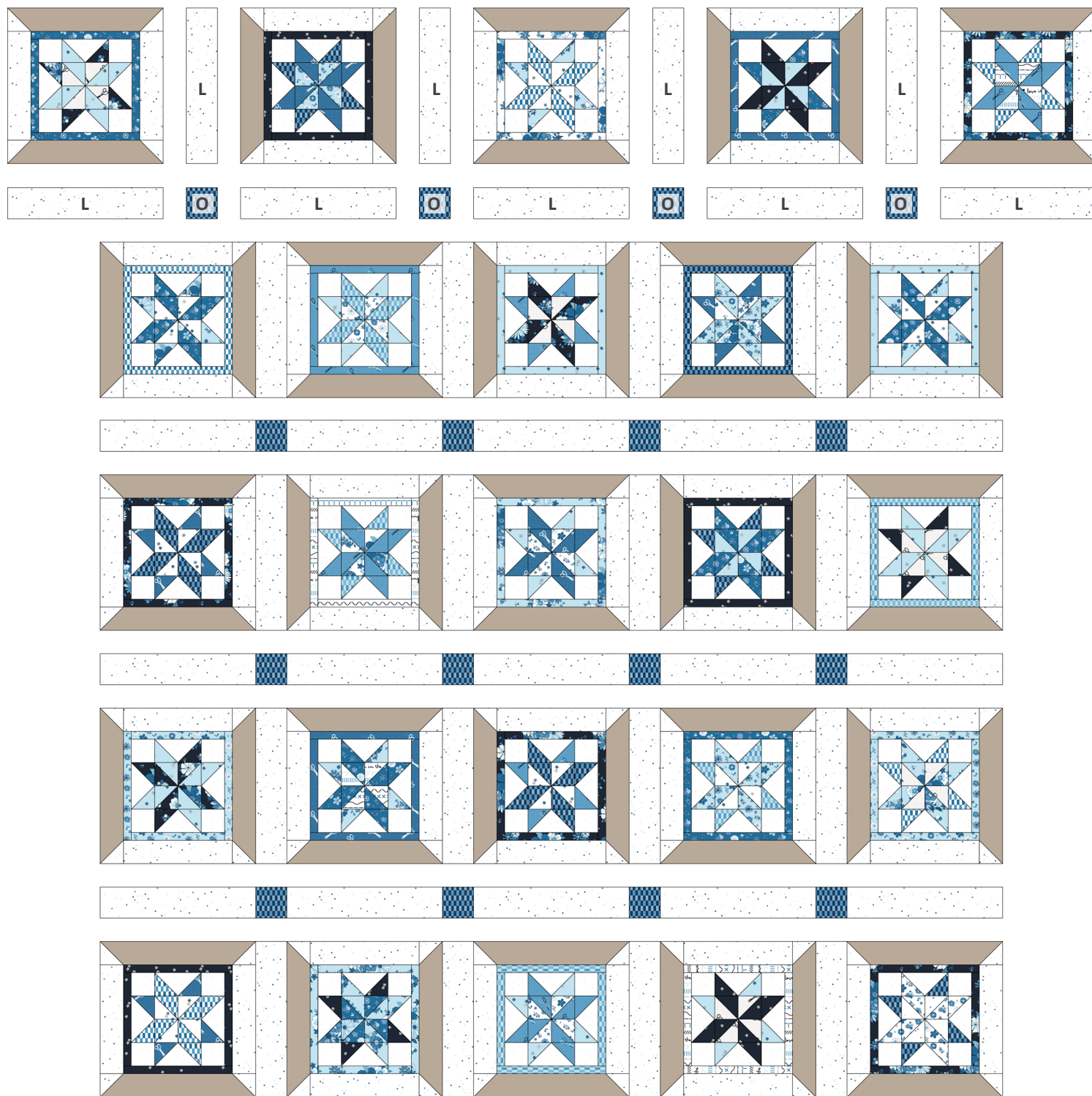

58 ½" x 58 ½"