

CAMPING LIFE

Riley Blake
DESIGNS®

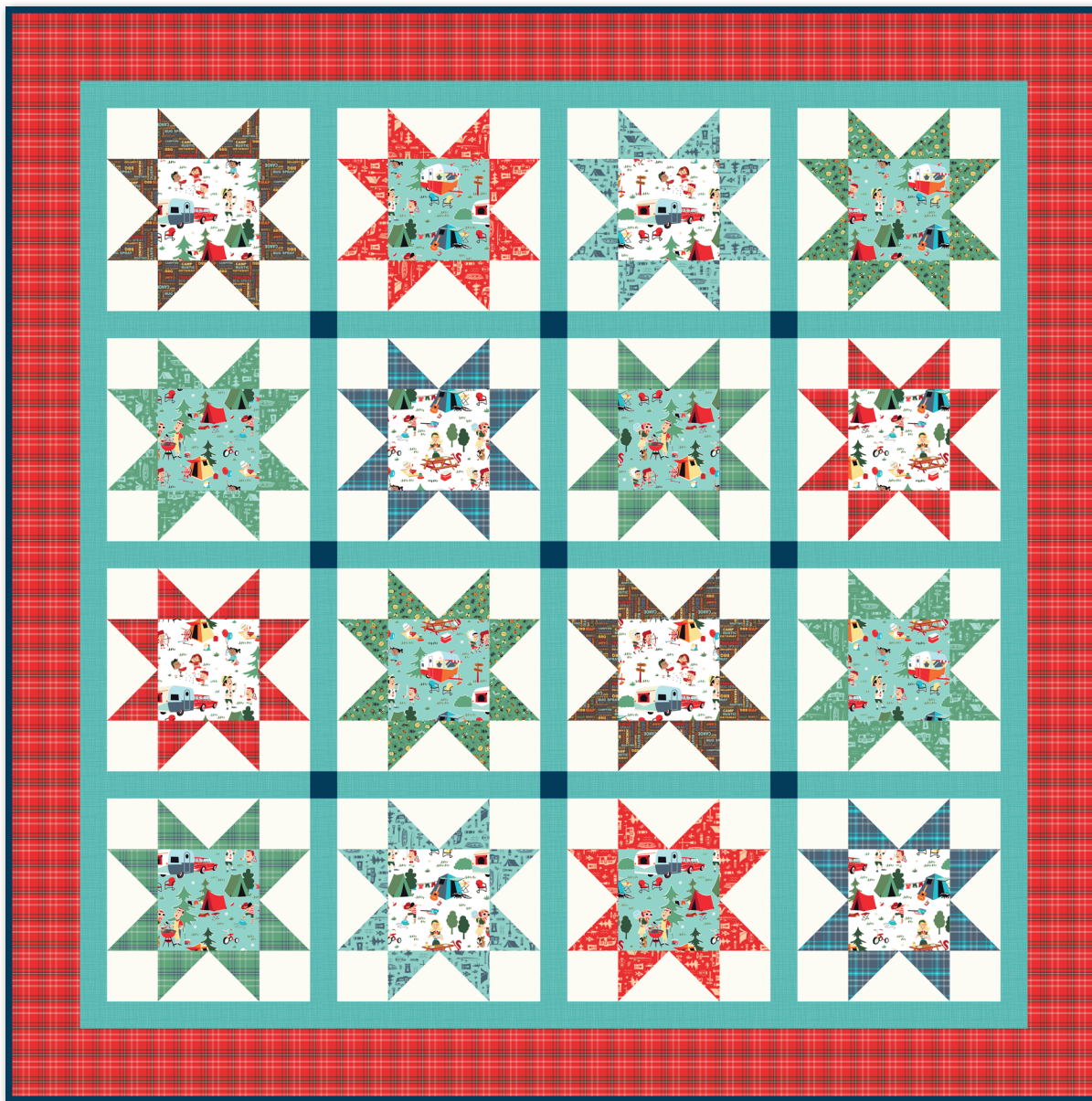

80 1/2" x 80 1/2"



= Confident Beginner



05/01/2026

CAMPING LIFE

FINISHED QUILT SIZE 80 ½" × 80 ½"

Please read all instructions before beginning this project. Yardage calculated using a 42" usable width of fabric.

Pattern designed by The RBD Designers.

GENERAL INSTRUCTIONS

Please check www.rileyblakedesigns.com/pattern-updates or scan the QR Code for any revisions before starting this project.

This pattern requires a basic knowledge of quilting techniques and terminology. The quilt and block diagrams portrayed are virtual images. The layout and look of your project may differ when using actual fabric. It is not recommended to prewash fabric before cutting and assembling.



WOF = Width of Fabric
RST = Right Sides Together
HST = Half Square Triangle

FABRIC REQUIREMENTS

Fabric is from the Happy Haven collection unless stated otherwise.

(1) 10-17620-42 10" Stacker

½ Yard of Each:

C17620-AQUA Main

C17620-WHITE Main

Additional Fabrics:

1 ½ yards C17625-RED Plaid

1 ¾ yards C610-GLACIER Texture

2 ¼ yards C120-CLOUD Confetti Cotton™ Solid

¾ yard C120-OXFORDBLUE Confetti Cotton™ Solid
(includes binding)



OTHER SUPPLIES

Basic Sewing Supplies

2 ½ yards WB6422-BLUE Bee Backing (wide back backing)

Batting

CUTTING INSTRUCTIONS

When cutting fabrics, use a straight edge ruler and rotary cutter. Measurements include ¼" seam allowance. Label, allocate, and organize all cuts as noted.

To make the quilt exactly as shown, refer to the cover and the Quilt Layout Diagram on page 5 to plan your placement of the 10" Stacker squares.



10" Stacker

Choose (16) 10" squares for star points. Label as A and set aside.



Aqua Main

Cut (2) 8" × WOF strips. Subcut:
(8) 8" × 8" squares. Label as B.



White Main

Cut (2) 8" × WOF strips. Subcut:
(8) 8" × 8" squares. Label as B.



Red Plaid

Cut (8) 5 ½" × WOF strips. Piece together end-to-end; subcut:
(2) 5 ½" × 80 ½" strips. Label as C.
(2) 5 ½" × 70 ½" strips. Label as D.



Glacier Texture

Cut (19) 2 ½" × WOF strips. Piece (7) together end-to-end; subcut:
(2) 2 ½" × 70 ½" strips. Label as E.
(2) 2 ½" × 66 ½" strips. Label as F.
From remaining strips, cut:
(24) 2 ½" × 15 ½" rectangles. Label as G.



Cloud Confetti Cotton™ Solid

Cut (4) 10" × WOF strips. Subcut:
(16) 10" × 10" squares. Label as H.
Cut (8) 4 ¼" × WOF strips. Subcut:
(64) 4 ¼" × 4 ¼" squares. Label as I.



Oxford Blue Confetti Cotton™ Solid

Cut (10) 2 ½" × WOF strips. Set (9) aside for binding. From the remaining strip, cut
(9) 2 ½" × 2 ½" squares. Label as J.

CAMPING LIFE

SEWING TECHNIQUES

Sew all seams RST and with a $\frac{1}{4}$ " seam allowance unless stated otherwise. Refer to the Quilt Layout Diagram for placement of the fabrics. Press seams as desired unless stated otherwise. Dimensions listed in steps are unfinished sizes. Please refer to the following general sewing technique as this method is referenced throughout the pattern in its abbreviated form.

8-AT-A-TIME HALF SQUARE TRIANGLE METHOD (HST)

Place (2) squares RST. Draw a diagonal line in both directions on the wrong side of one square. Sew $\frac{1}{4}$ " from both sides of each drawn line. Cut on the drawn lines and through the vertical and horizontal center to create (8) HSTs. Press toward the darker fabric. Trim HSTs to the indicated size.

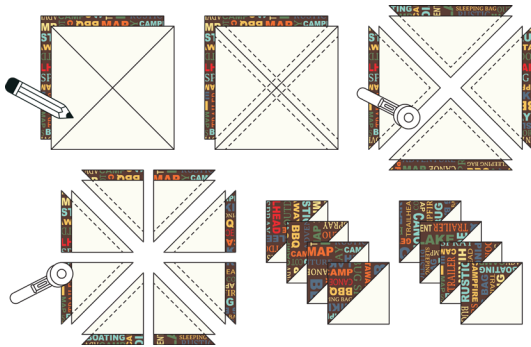

BLOCK ASSEMBLY

1. Gather (1) **A**-square, (1) **H**-square, (1) **B**-square, and (4) **I**-squares.
2. Use the 8-at-a-time HST method using (1) **A**-square and (1) **H**-square to make (8) matching HST units. Trim each unit to measure $4\frac{1}{4}'' \times 4\frac{1}{4}''$.

Make (8)

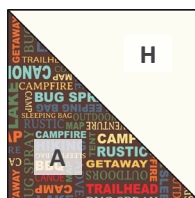

$4\frac{1}{4}'' \times 4\frac{1}{4}''$

3. Sew (2) HST units together as shown below to make (1) Star Point Unit. Repeat to make (4) total units.

Make (4)

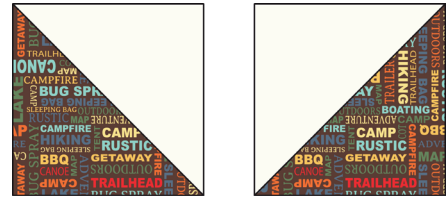

$4\frac{1}{4}'' \times 8''$

4. Arrange (4) **I**-squares, (4) Star Point Units, and (1) **B**-square as shown below. Sew the squares and units together into rows. Next, sew the rows together to make (1) Star Block.
5. Repeat steps 1-4 to make (16) total blocks.

Make (16)

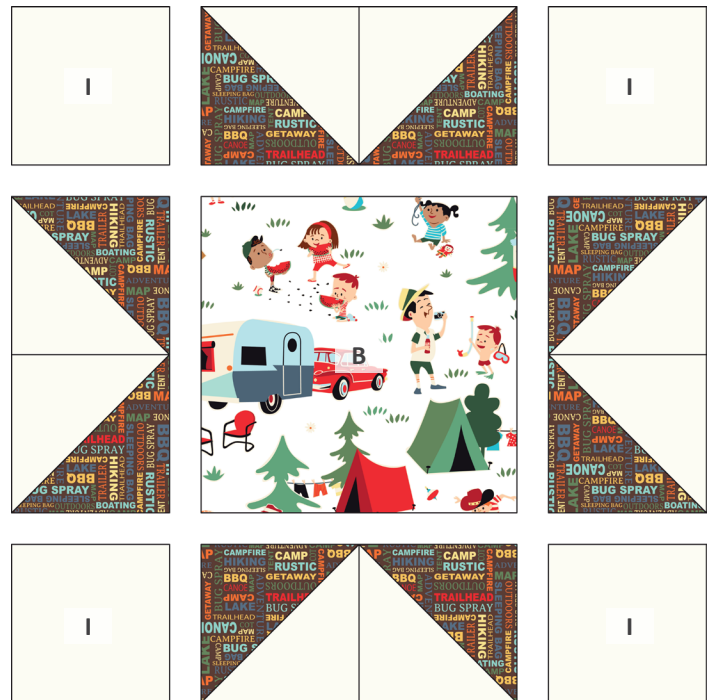

$15\frac{1}{2}'' \times 15\frac{1}{2}''$

CAMPING LIFE

QUILT ASSEMBLY

6. Arrange (16) Star Blocks, (24) **G**-rectangles, and (9) **J**-squares as shown below, alternating the Star Blocks with the White Main fabric center and the Aqua Main center fabric. Sew the blocks and pieces together into rows. Next, sew the rows together to make the quilt center.

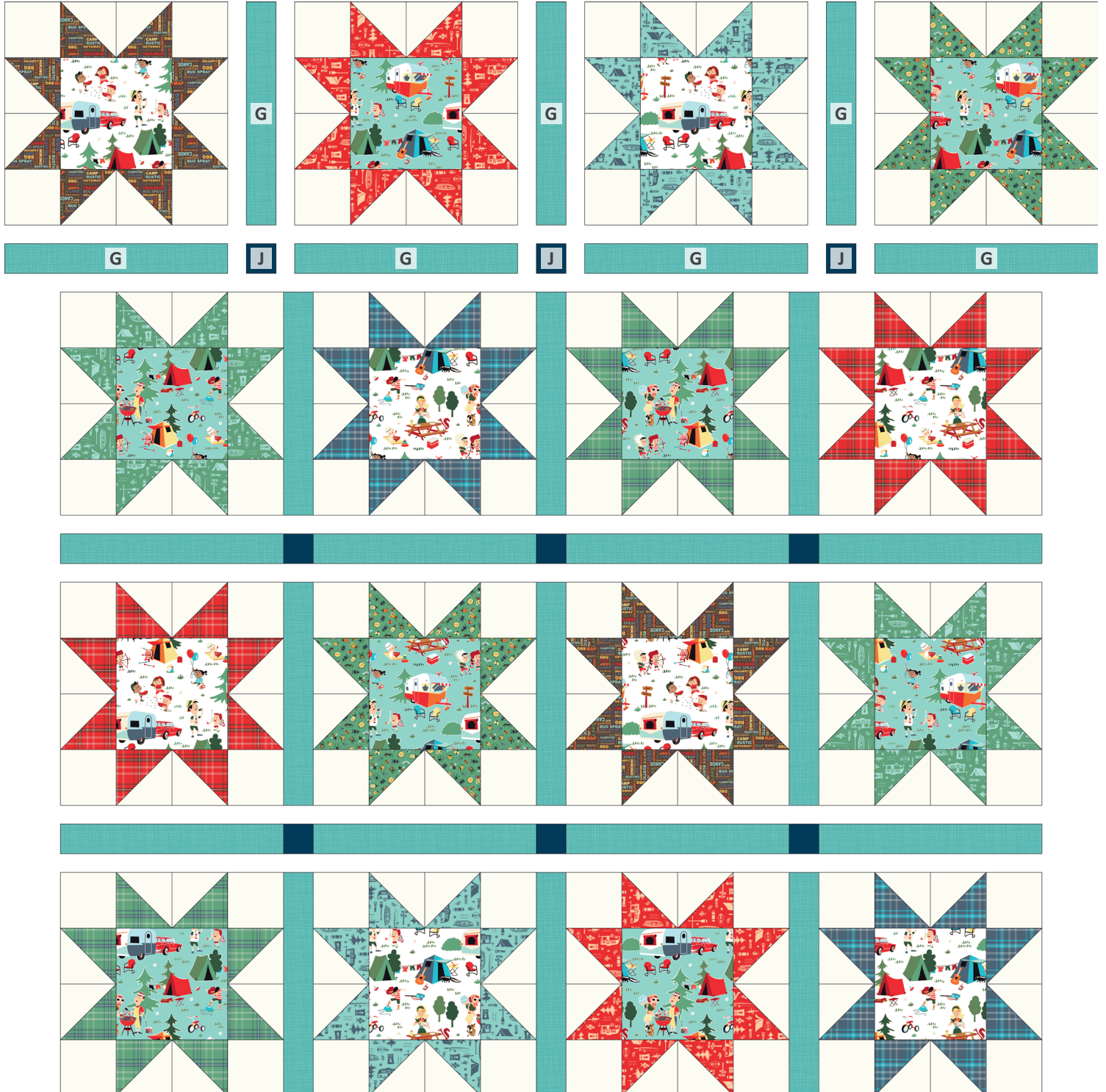

66 1/2" x 66 1/2"

CAMPING LIFE

7. Sew (1) **F**-strip to each side of the quilt center. Next, sew (1) **E**-strip to the top and bottom. In the same manner, sew **D**-strips to the sides and **C**-strips to the top and bottom to complete the quilt top.

QUILT LAYOUT DIAGRAM

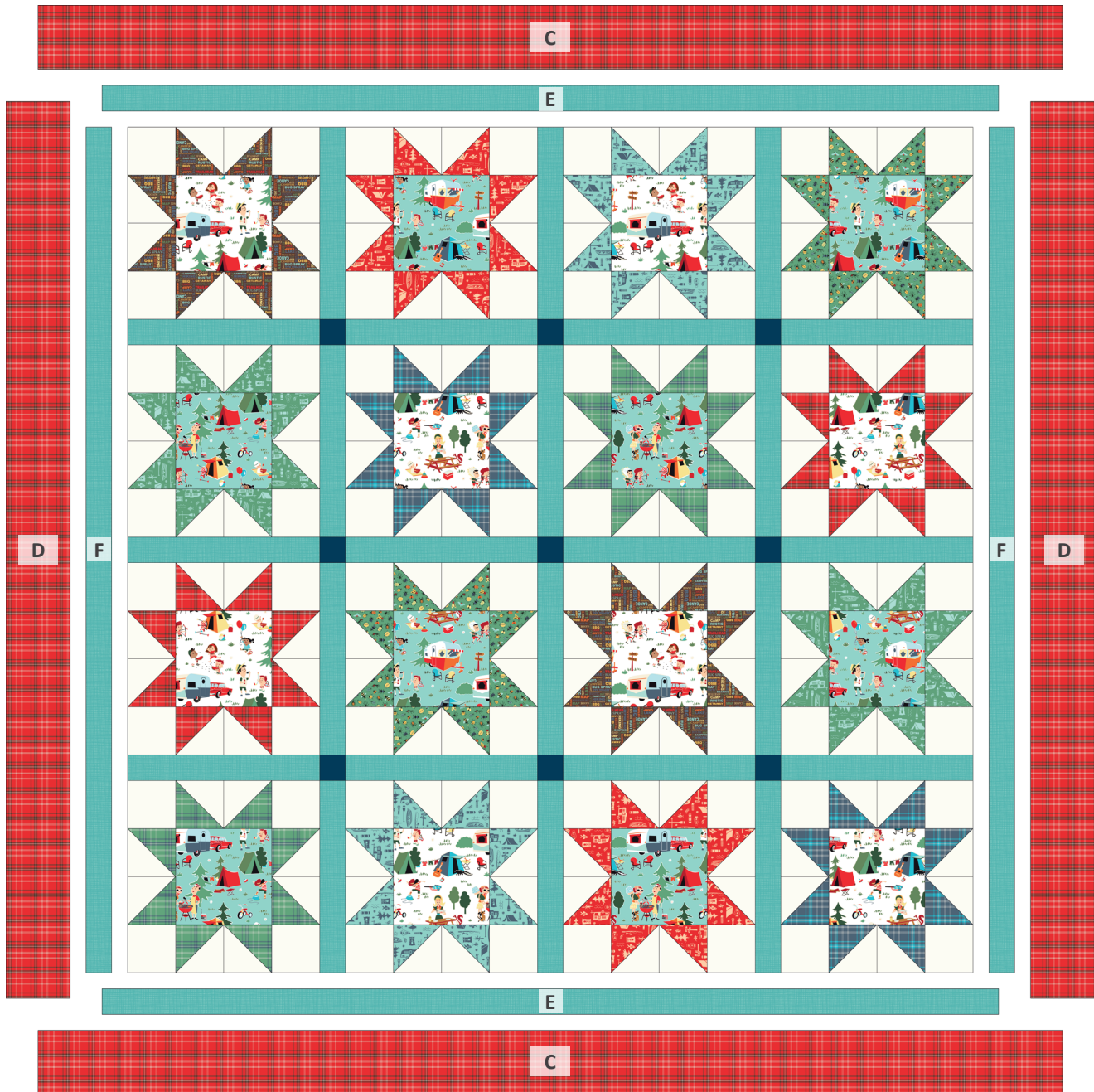

80 1/2" x 80 1/2"

FINISHING INSTRUCTIONS

8. Layer the quilt top, batting, and backing. Baste the quilt layers together and quilt as desired. Sew the Oxford Blue Confetti Cotton™ Solid binding strips together end-to-end. Then bind the trimmed, finished quilt using your favorite binding method.

Enjoy and share your quilt using the hashtags: [#happyhavenfabric](#), [#campinglifequilt](#), [#rileyblakedesigns](#), and [#iloverileyblake](#).