

WINTER SPIRIT

Riley Blake
DESIGNS®



59 1/2" x 65 1/2"

Holiday Spirit
by Lisa Audit



= Confident Beginner

05/01/2026

WINTER SPIRIT

FINISHED QUILT SIZE 59 ½" × 65 ½"

Please read all instructions before beginning this project.
Yardage calculated using a 42" usable width of fabric.
Pattern designed by The RBD Designers.

GENERAL INSTRUCTIONS

Please check www.rileyblakedesigns.com/pattern-updates or scan the QR Code for any revisions before starting this project. This pattern requires a basic knowledge of quilting techniques and terminology. The quilt and block diagrams portrayed are virtual images. The layout and look of your project may differ when using actual fabric. It is not recommended to prewash fabric before cutting and assembling.



Always verify your panel size before beginning. If your panel measurements differ from those given in the pattern, trim to the desired size or use coping strips to alter the size of your panel. If coping strips are needed, add oversized, coordinating strips of fabric to the necessary edges of the panel, then trim to the size specified in the pattern.

WOF = Width of Fabric
RST = Right Sides Together
SNF = Stitch and Flip

FABRIC REQUIREMENTS

Fabric is from the Holiday Spirit collection unless stated otherwise.

(1) PD17466-PANEL Season's Greetings Wreath Panel

⅓ Yard of Each:

C17465-RED Stripes
C120-SHRUBS Confetti Cotton™ Solid



½ Yard of Each:

CD17461-RED Christmas Toss
CD17464-GREEN Pinecones

Additional Fabrics:

1 ⅔ yards CD17463-CREAM Berries
¾ yard CD17462-RED Holly (includes binding)

OTHER SUPPLIES

Basic Sewing Supplies
1 ⅞ yards WB640-BARNRED Dapple Dot (wide back backing)
Batting

CUTTING INSTRUCTIONS

When cutting fabrics, use a straight edge ruler and rotary cutter. Measurements include ¼" seam allowance. Label, allocate, and organize all cuts as noted.



Season's Greetings Wreath Panel

Fussy cut (1) 35" × 41" Panel rectangle, centered over the motif.*

*Note: If the panel motif does not reach the edge of the required cut, add coping strips first and then trim to the required size.

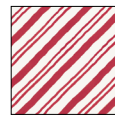

Red Stripes

Cut (1) 3 ½" × WOF strip. Subcut:
(4) 3 ½" × 3 ½" squares. Label as A.



Shrubs Confetti Cotton™ Solid

Cut (2) 2" × WOF strips. Subcut:
(32) 2" × 2" squares. Label as B.



Red Christmas Toss

Cut (4) 3 ¾" × WOF strips. Subcut:
(2) 3 ¾" × 41 ½" rectangles. Label as C.
(2) 3 ¾" × 41" rectangles. Label as D.



Green Pinecones

Cut (4) 3 ½" × WOF strips. Subcut:
(4) 3 ½" × 19 ½" rectangles. Label as E.
(4) 3 ½" × 16 ½" rectangles. Label as F.
(4) 3 ½" × 3 ½" squares. Label as G.

WINTER SPIRIT



Cream Berries

Cut (13) $3\frac{1}{2}$ " \times WOF strips. Subcut:
 (8) $3\frac{1}{2}$ " \times $19\frac{1}{2}$ " rectangles. Label as H.
 (8) $3\frac{1}{2}$ " \times $16\frac{1}{2}$ " rectangles. Label as I.
 (64) $3\frac{1}{2}$ " \times $3\frac{1}{2}$ " squares. Label as J.



Red Holly

Cut (7) $2\frac{1}{2}$ " \times WOF strips. Set aside for binding.
 Cut (2) 2" \times WOF strips. Subcut:
 (32) 2" \times 2" squares. Label as K.

SEWING TECHNIQUES

Sew all seams RST and with a $\frac{1}{4}$ " seam allowance unless stated otherwise. Refer to the Quilt Layout Diagram for placement of the fabrics. Press seams as desired unless stated otherwise. Dimensions listed in steps are unfinished sizes. Please refer to the following general sewing technique as this method is referenced throughout the pattern in its abbreviated form.

STITCH AND FLIP METHOD (SNF)

Place (2) pieces RST, matching raw edges in the corner to be replaced. Draw a diagonal line on the wrong side of the smaller piece across the corner. Sew on the drawn line. Trim the seam allowance outside the sewn line to $\frac{1}{4}$ ". Flip the smaller piece away from the larger piece and press, replacing the corner. The size of the larger, original piece does not change.

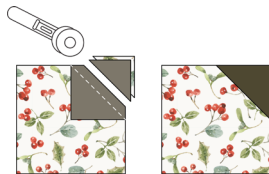

BLOCK ASSEMBLY

- Use the SNF method to make the units shown below, referencing the diagrams for quantity, proper placement, and orientation.

Make (16)



$3\frac{1}{2}$ " \times $3\frac{1}{2}$ "

Make (16)

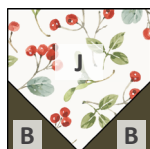

$3\frac{1}{2}$ " \times $3\frac{1}{2}$ "

- Arrange (4) J-squares, (4) J/K SNF units, and (1) A-square as shown below. Sew the squares and units together into rows. Next, sew the rows together to make (1) Red Star Block. Repeat to make (4) total blocks.

Make (4)

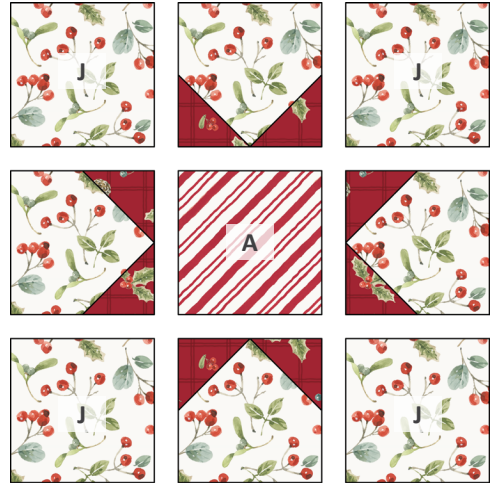

$9\frac{1}{2}$ " \times $9\frac{1}{2}$ "

- Arrange (4) J-squares, (4) B/J SNF units, and (1) G-square as shown below. Sew the squares and units together into rows. Next, sew the rows together to make (1) Green Star Block. Repeat to make (4) total blocks.

Make (4)

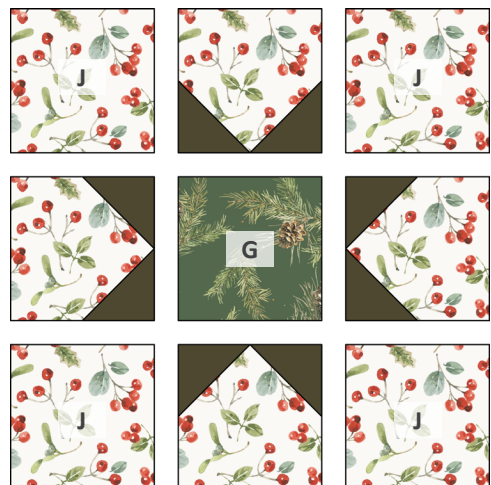

$9\frac{1}{2}$ " \times $9\frac{1}{2}$ "

WINTER SPIRIT

QUILT ASSEMBLY

4. Sew (1) **D**-rectangle to each side of the Panel rectangle. Next, sew (1) **C**-rectangle to the top and bottom to make the quilt center.



41 1/2" x 47 1/2"

5. Sew (2) **I**-rectangles and (1) **F**-rectangle together as shown below to make (1) Short Border Unit. Repeat to make (4) total units.

Make (4)



9 1/2" x 16 1/2"

6. Sew (2) Red Star Blocks, (2) Short Border Units, and (1) Green Star Block together as shown below to make (1) Top Border Unit. Repeat to make (1) Bottom Border Unit.

Make (2)

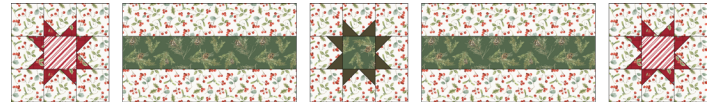

9 1/2" x 59 1/2"

7. Sew (2) **H**-rectangles and (1) **E**-rectangle together as shown below to make (1) Long Border Unit. Repeat to make (4) total units.

Make (4)



9 1/2" x 19 1/2"

8. Sew (2) Long Border Units and (1) Green Star Block together as shown below to make (1) Side Border Unit. Repeat to make a second Side Border Unit.

Make (2)

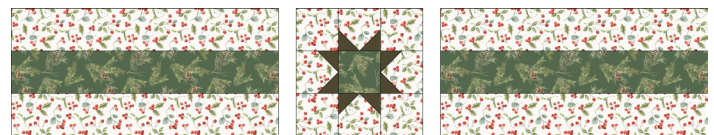

9 1/2" x 47 1/2"

9. Sew (1) Side Border Unit to each side of the quilt center as shown in the Quilt Layout Diagram on page 5. Next, sew (1) Top/Bottom Border Unit to the top and bottom to complete the quilt top.

FINISHING INSTRUCTIONS

10. Layer the quilt top, batting, and backing. Baste the quilt layers together and quilt as desired. Sew the Red Holly binding strips together end-to-end. Then bind the trimmed, finished quilt using your favorite binding method.

Enjoy and share your quilt using the hashtags:

[#holidayspiritfabric](#), [#winterspiritquilt](#), [#rileyblakedesigns](#), and [#iloverileyblake](#).

WINTER SPIRIT

QUILT LAYOUT DIAGRAM



59 1/2" x 65 1/2"