



STARRY LATTICE QUILT



by JENNIFER BOSWORTH

for  **Riley Blake**
DESIGNS[®]



Finished size: 73½" × 73½"

A FREE PATTERN FROM **ShabbyFabrics[®].com**

© 2026 Shabby Fabrics

REQUIRED MATERIALS



10" Stacker
10-16830-42
(1) pack



pink petals
CPL16831-RASPBERRY
 $\frac{7}{8}$ yard



white pearl dot
CPL850-WHITE
3 yards

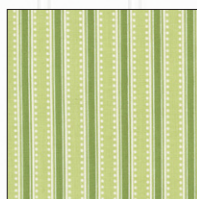

green stripe
CPL16834-GREEN
 $\frac{2}{3}$ yard



cream main floral
CPL16830-MULTI
 $2\frac{1}{4}$ yard



green text
CPL16833-GREEN
 $\frac{2}{3}$ yard



SUGGESTED BACKING:

cream ditsy floral
C16832-CREAM
 $4\frac{3}{4}$ yard

RECOMMENDED NOTIONS

- Creative Grids Ultimate Flying Geese Tool - #CGRDH4
- Creative Grids $6\frac{1}{2}$ " x $24\frac{1}{2}$ " Ruler - #CGR24

© 2026 Shabby Fabrics

For personal use ONLY, not for commercial use.

All designs, photographs, and images are protected by federal copyright law.

All rights reserved.

NOTE

All seams are $\frac{1}{4}$ "

WOF = Width of Fabric

LOF = Length of Fabric

RST = Right Sides Together

Refer to arrows for pressing instructions. Arrows that point in both directions \longleftrightarrow indicate a seam that is pressed open.

CUT FABRICS



Select (12) colorful squares from 10" precut pack.

From **each** of (12) squares, cut:

- (4) $4\frac{1}{4}$ " \times $4\frac{1}{4}$ " for **flying geese**



From **white pearl dot**, cut:

- (12) $7\frac{3}{4}$ " \times $7\frac{3}{4}$ " for **flying geese**
- (52) $3\frac{1}{2}$ " \times $6\frac{1}{2}$ " for **block sides**
- (2) $3\frac{1}{2}$ " \times WOF for **strip-pieced 9-patch**
- (48) $3\frac{1}{2}$ " \times $3\frac{1}{2}$ " for **star block corners**
- (5) 2" \times WOF for **strip-pieced 4-patch**
- (4) 2" \times WOF for **strip-pieced 9-patch**

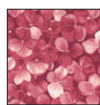

From **pink petals**, cut:

- (2) $3\frac{1}{2}$ " \times WOF for **strip-pieced 9-patch**
- (5) 2" \times WOF for **strip-pieced 4-patch**
- (4) 2" \times WOF for **strip-pieced 9-patch**



Select (12) colorful squares from 10" precut pack.

From **each** of (12) squares, cut:

- (1) $6\frac{1}{2}$ " \times $6\frac{1}{2}$ " for **block centers**



From **green stripe**, cut:

- (7) 2" \times WOF, pieced and subcut to
 - (2) 2" \times $63\frac{1}{2}$ " for **top/bottom inner border**
 - (2) 2" \times $60\frac{1}{2}$ " for **side inner border**



From **large floral**, cut **down length of fabric**:

- (4) $5\frac{1}{2}$ " \times WOF, subcut to
 - (2) $5\frac{1}{2}$ " \times $73\frac{1}{2}$ " for **top/bottom outer border**
 - (2) $5\frac{1}{2}$ " \times $63\frac{1}{2}$ " for **side outer border**



From **green text**, cut:

- (8) $2\frac{1}{2}$ " \times WOF for **binding**

STRIP-PIECED 4-PATCH UNITS

Sew (1) 2" white strip to (1) 2" pink strip. Press toward pink. Repeat to make a total of (5) strip sets.

Cut strip sets into 2" sections to make a total of (104) strip-pieced units. Each unit should measure 2" \times $3\frac{1}{2}$ ".

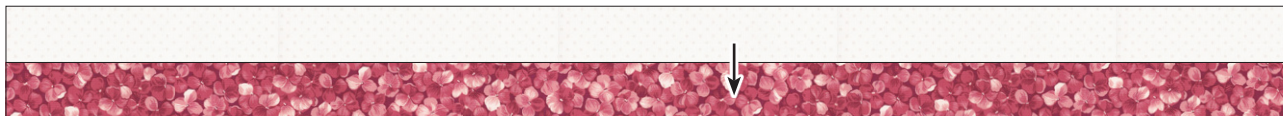

Cut (104)

Refer to image (*right*) to arrange units to a 4-patch unit.

Sew units together, pressing to one side.

Make a total of (52) 4-patch units. Each unit should measure $3\frac{1}{2}$ " \times $3\frac{1}{2}$ ".

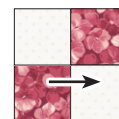

4-Patch unit
Make (52)

STRIP-PIECED 9-PATCH UNITS

Sew (2) 2" pink strips to the top and bottom of (1) 3½" white strip. Repeat to make a total of (2) strip sets.

Cut strip sets into 2" sections to make a total of (26) strip-pieced units. Each unit should measure 2" × 6½".

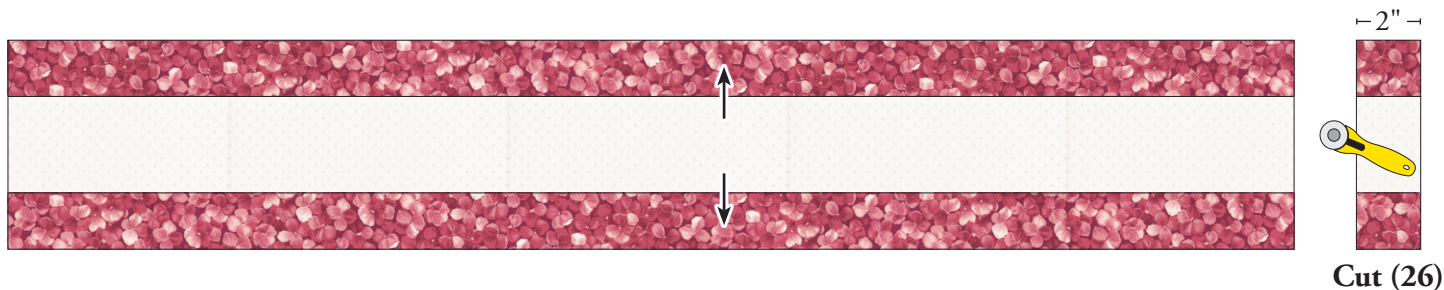

Sew (2) 2" white strips to the top and bottom of (1) 3½" pink strip. Repeat to make a total of (2) strip sets.

Cut strip sets into 3½" sections to make a total of (13) strip-pieced units. Each unit should measure 3½" × 6½".

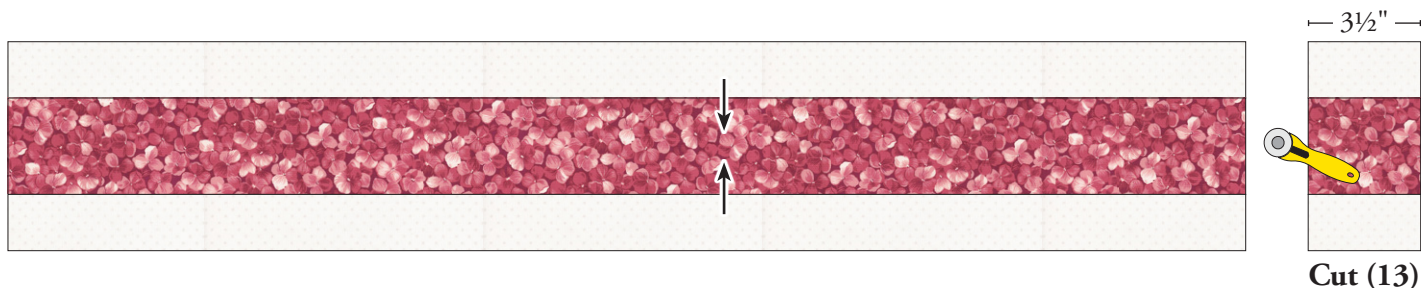

Refer to image (*right*) to arrange units to a 9-patch unit.

Sew units together.

9-patch unit should measure 6½" × 6½".

Make a total of (13) 9-patch units.

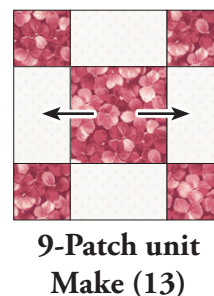

IRISH CHAIN BLOCKS

Refer to block assembly diagram (*right*) to arrange 4-patch units, 9-patch units, and **block sides**.

Sew units together in rows.

Sew rows together.

Block should measure 12½" × 12½".

Make a total of (13) Irish Chain blocks.

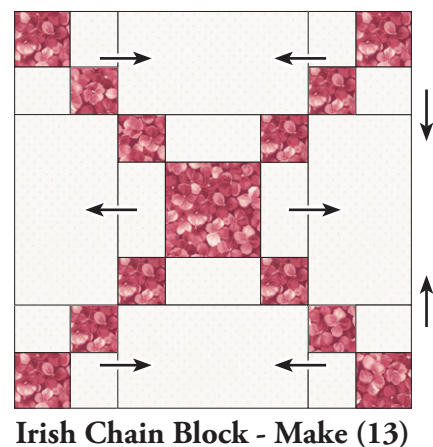

FLYING GEESE UNITS

We used the *Creative Grids Ultimate Flying Geese Tool* to create our flying geese units. This tool provides for oversizing the unit, then using the tool to trim accurately. If using this tool, use the marks for a Finished Size of 3" x 6" (lines labeled "F").

STEP 1: Draw a diagonal line on the back of all $4\frac{1}{4}" \times 4\frac{1}{4}"$ squares. Place (2) $4\frac{1}{4}" \times 4\frac{1}{4}"$ squares in opposite corners of (1) $7\frac{3}{4}" \times 7\frac{3}{4}"$ white square, RST, and pin in place. To reduce bulk, trim overlapping corners. Sew $\frac{1}{4}"$ along each side of the drawn line. Cut on drawn line. You will now have (2) units.

STEP 2: Place a $4\frac{1}{4}" \times 4\frac{1}{4}"$ square on the corner of each unit, RST. Sew $\frac{1}{4}"$ along each side of the drawn line on each unit. Cut on the drawn line.

You will now have (4) flying geese units.

IMPORTANT: Use Creative Grids Ultimate Flying Geese Tool (or your preferred ruler) to trim each flying geese unit to $3\frac{1}{2}" \times 6\frac{1}{2}"$.

Repeat to make a total of (48) flying geese units.

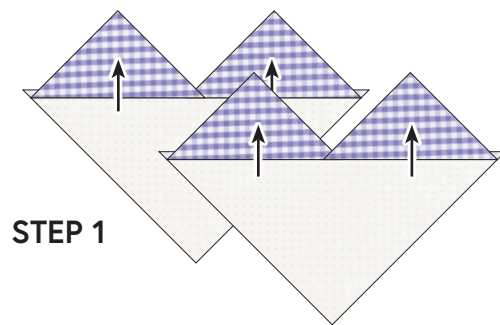
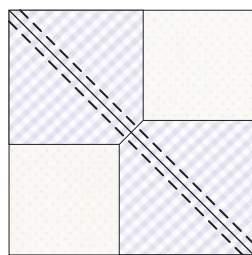

STEP 1

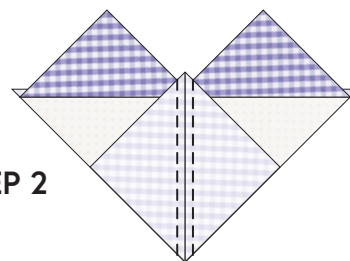
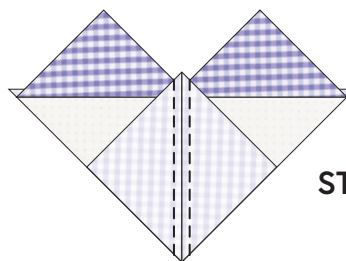

STEP 2

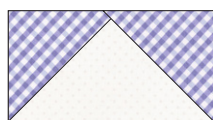
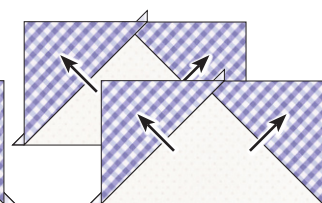
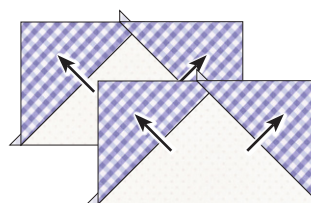

Make (4)



Make (4)



Make (4)



Make (4)



Make (4)

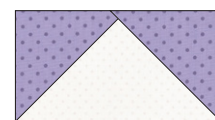

Make (4)



Make (4)



Make (4)



Make (4)



Make (4)

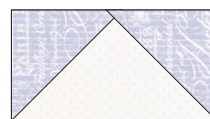

Make (4)



Make (4)

STAR BLOCKS

Refer to block assembly diagram (right) to arrange **star block corners**, flying geese units, and **block centers**.

Sew units together in rows.

Sew rows together.

Block should measure $12\frac{1}{2}" \times 12\frac{1}{2}"$.

Make a total of (12) Star blocks.

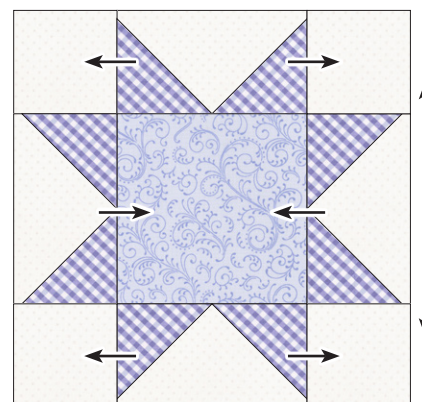

Star Block - Make (12)

ASSEMBLE QUILT

Refer to diagram (below).

Sew blocks together in rows. Sew rows together. Quilt top should measure 60½" × 60½".

Sew **side inner border** to left and right sides of quilt. Sew **top/bottom inner border** to top and bottom of quilt.

Sew **side outer border** to left and right sides of quilt. Sew **top/bottom outer borders** to top and bottom of quilt.

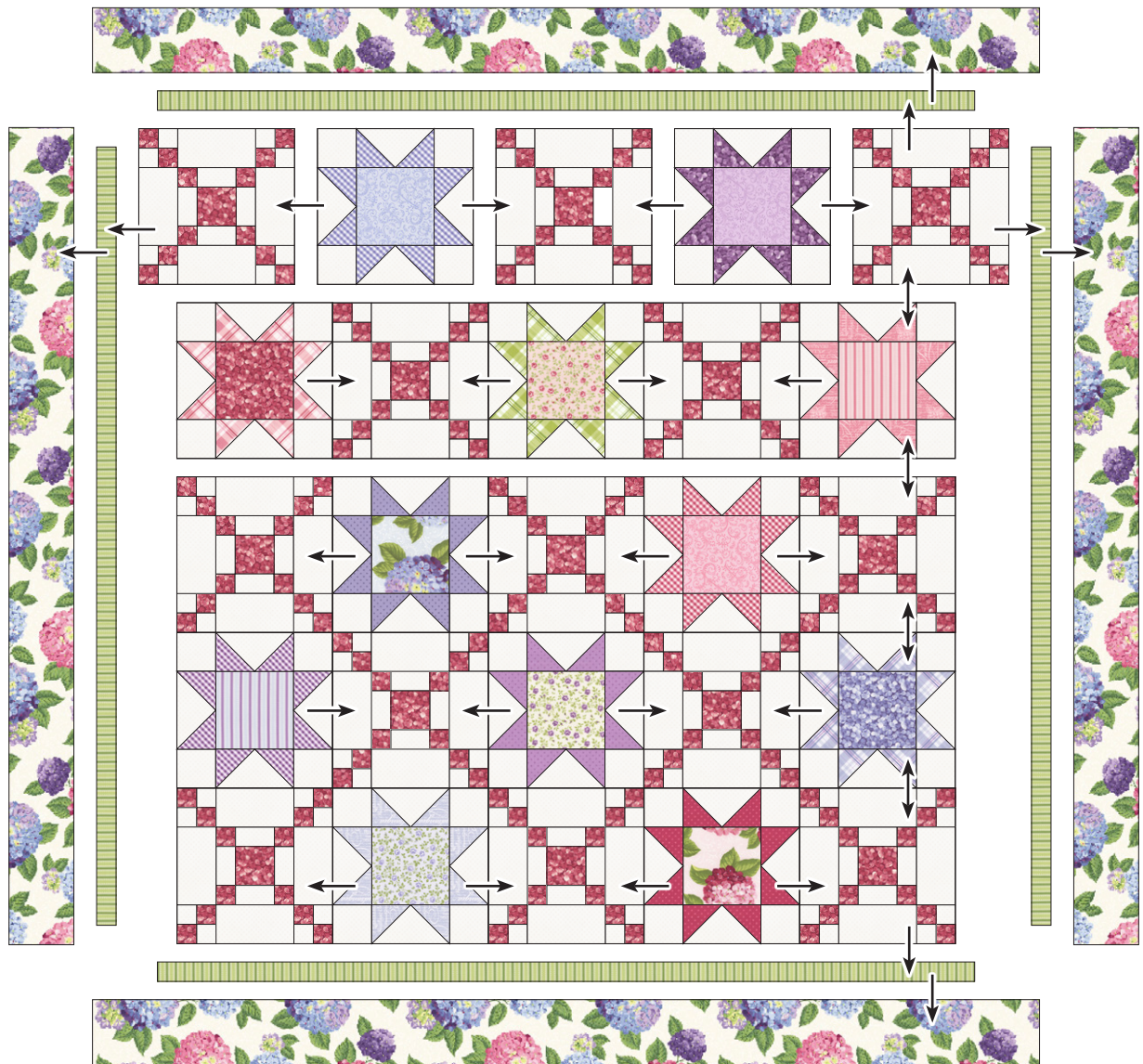

FINISH QUILT

Layer quilt top, batting, and backing. Quilt as desired.

Sew **binding** into one continuous strip. Fold binding in half lengthwise, wrong sides together, and press. Line up raw edges of binding with the raw edge of the quilt. Sew the binding to the front side of the quilt, starting at any side. Turn the binding over and machine stitch or hand sew to the back of the quilt.

Shop 24/7 at ShabbyFabrics.com for beautiful BOMs and clubs, kits, fabrics, notions, and more!