

ROSE GARDEN PANEL QUILT



44 ½" x 52 ½"



= Confident Beginner



12/01/2025

ROSE GARDEN PANEL QUILT

FINISHED QUILT SIZE 44 ½" × 52 ½"

Please read all instructions before beginning this project.
Yardage calculated using a 42" usable width of fabric.

Pattern designed by The RBD Designers.

GENERAL INSTRUCTIONS

Please check www.rileyblakedesigns.com/pattern-updates or scan the QR Code for any revisions before starting this project. This pattern requires a basic knowledge of quilting techniques and terminology. The quilt and block diagrams portrayed are virtual images. The layout and look of your project may differ when using actual fabric. It is not recommended to prewash fabric before cutting and assembling.



Always verify your panel size before beginning. If your panel measurements differ from those given in the pattern, trim to the desired size or use coping strips to alter the size of your panel. If coping strips are needed, add oversized, coordinating strips of fabric to the necessary edges of the panel, then trim to the size specified in the pattern.

WOF = Width of Fabric
RST = Right Sides Together
SNF = Stitch and Flip
HST = Half Square Triangle

FABRIC REQUIREMENTS

Fabric is from the Rose & Violet's Bouquet des Fleurs collection unless stated otherwise.

(1) PD17298-PANEL Rose Garden Panel

5" Square of Each:

C17290-CREAM Bouquet
C17291-CREAM Posy
C17293-PEACH Stripes

10" Square of Each:

C17290-BLUSH Bouquet
C17290-MINT Bouquet
C17290-TAN Bouquet
C17291-BLUSH Posy
C17291-MINT Posy
C17292-BLUE Lace
C17293-CREAM Stripes
C17295-PARCHMENT Melody
C17296-PARCHMENT Poem

Fat ¼ of Each:

C17294-MINT Dots
C17294-PEACH Dots

¾ Yard of Each:

C17293-MINT Stripes
C17294-CREAM Dots

Additional Fabrics:

Fat ⅙ C17292-BLUSH Lace
⅝ yard C17292-CREAM Lace
½ yard C17294-BLUE Dots (includes binding)

OTHER SUPPLIES

Basic Sewing Supplies
1 ¾ yards WB200-ROBIN Shade (wide back backing)
Batting

CUTTING INSTRUCTIONS

When cutting fabrics, use a straight edge ruler and rotary cutter. Measurements include ¼" seam allowance. Label, allocate, and organize all cuts as noted.



Rose Garden Panel

Fussy cut (4) 11 ½" × 14 ½" Panel rectangles, centered over the motifs.* (This quilt uses the motifs in the center and right columns.)

**Note: If the panel motifs do not reach the edges of the required cuts, add coping strips first and then trim to the required sizes.*



5" Squares

From each 5" square, cut:

(1) 4 ½" × 4 ½" square. Label as A.

ROSE GARDEN PANEL QUILT



Blush Bouquet

From 10" square, cut:
(6) 3" x 3" squares. Label as B.



Mint Bouquet

From 10" square, cut:
(1) 4 1/2" x 4 1/2" square. Label as A.
(2) 3" x 3" squares. Label as B.



Tan Bouquet

From 10" square, cut:
(1) 4 1/2" x 4 1/2" square. Label as A.
(2) 3" x 3" squares. Label as B.



Blush Posy

From 10" square, cut:
(6) 3" x 3" squares. Label as B.



Mint Posy

From 10" square, cut:
(6) 3" x 3" squares. Label as B.



Blue Lace

From 10" square, cut:
(8) 3" x 3" squares. Label as B.



Cream Stripes

From 10" square, cut:
(3) 4 1/2" x 4 1/2" squares. Label as A.



Parchment Melody

From 10" square, cut:
(4) 3" x 3" squares. Label as B.



Parchment Poem

From 10" square, cut:
(6) 3" x 3" squares. Label as B.



Blush Lace

From Fat 1/8, cut:
(3) 4 1/2" x 4 1/2" squares. Label as A.
(2) 3" x 3" squares. Label as B.



Mint Dots

From Fat 1/4, cut:
(2) 4 1/2" x 4 1/2" squares. Label as A.
(2) 3" x 3" squares. Label as B.
(2) 2 1/2" x 12 1/2" rectangles. Label as C.
(2) 1 1/2" x 14 1/2" rectangles. Label as D.

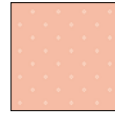

Peach Dots

From Fat 1/4, cut:
(4) 3" x 3" squares. Label as B.
(2) 2 1/2" x 12 1/2" rectangles. Label as E.
(2) 1 1/2" x 14 1/2" rectangles. Label as F.



Cream Lace

Cut (1) 4 1/2" x WOF strip. Subcut:
(1) 4 1/2" x 4 1/2" square. Label as A.
(2) 2 1/2" x 16 1/2" rectangles. Label as G.
Cut (5) 2 1/2" x WOF strips. Subcut:
(6) 2 1/2" x 20 1/2" rectangles. Label as H.
(4) 2 1/2" x 16 1/2" rectangles. Label as G.



Mint Stripes

Cut (1) 4 1/2" x WOF strip. Subcut:
(2) 4 1/2" x 4 1/2" squares. Label as A.
From remainder of strip, cut (2) 1 1/2"-wide strip; subcut:
(4) 1 1/2" x 16 1/2" rectangles. Label as I.
Cut (10) 1 1/2" x WOF strips. Subcut:
(12) 1 1/2" x 20 1/2" rectangles. Label as J.
(8) 1 1/2" x 16 1/2" rectangles. Label as I.



Cream Dots

Cut (4) 3" x WOF strips. Subcut:
(50) 3" x 3" squares. Label as K.
Cut (4) 2 1/2" x WOF strips. Subcut:
(64) 2 1/2" x 2 1/2" squares. Label as L.



Blue Dots

Cut (1) 3" x WOF strip. Subcut:
(2) 3" x 3" squares. Label as B.
From remainder of strip, cut (1) 2 1/2"-wide strip. Set aside for binding.
Cut (5) 2 1/2" x WOF strips. Set aside for binding.

SEWING TECHNIQUES

Sew all seams RST and with a 1/4" seam allowance unless stated otherwise. Refer to the Quilt Layout Diagram for placement of the fabrics. Press seams as desired unless stated otherwise. Dimensions listed in steps are unfinished sizes. Please refer to the following general sewing techniques as these methods are referenced throughout the pattern in their abbreviated form.

ROSE GARDEN PANEL QUILT

STITCH AND FLIP METHOD (SNF)

Place (2) pieces RST, matching raw edges in the corner to be replaced. Draw a diagonal line on the wrong side of the smaller piece across the corner. Sew on the drawn line. Trim the seam allowance outside the sewn line to $\frac{1}{4}$ ". Flip the smaller piece away from the larger piece and press, replacing the corner. The size of the larger, original piece does not change.

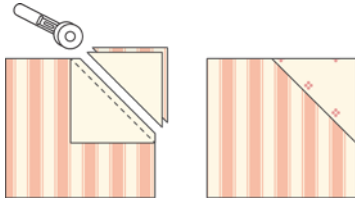

2-AT-A-TIME HALF SQUARE TRIANGLE METHOD (HST)

Place (2) squares RST. Draw a diagonal line on the wrong side of (1) square. Sew $\frac{1}{4}$ " on each side of the drawn line. Cut on the drawn line to create (2) HSTs. Press toward the darker fabric. Trim HSTs to the indicated size.

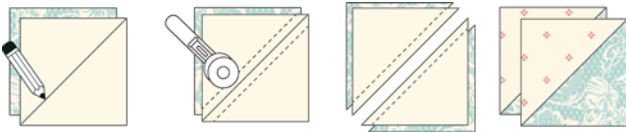

BLOCK ASSEMBLY

1. Gather the required pieces and use the 2-at-a-time HST method to make the unit shown below, referencing the diagram for quantity, proper placement, and orientation. (Note: This will make HST units in a variety of fabric combinations, not just the one shown below.)

Make (100)



$2\frac{1}{2}" \times 2\frac{1}{2}"$

2. Arrange (4) matching HST units as shown below. Sew the units together into pairs. Next, sew the pairs together to make (1) Pinwheel Block. Repeat to make (25) total blocks.

Make (25)

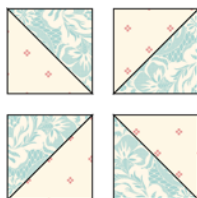

$4\frac{1}{2}" \times 4\frac{1}{2}"$

3. Use the SNF method to sew (1) L-square to each corner of (1) A-square as shown below to make (1) Square-in-a-Square Block. Repeat to make (16) total blocks. (Note: This will make the block in a variety of fabric combinations, not just the one shown below.)

Make (16)

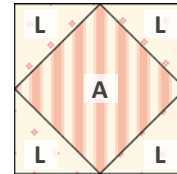

$4\frac{1}{2}" \times 4\frac{1}{2}"$

QUILT ASSEMBLY

4. Sew (2) Pinwheel Blocks and (2) Square-in-a-Square Blocks together as shown below to make (1) Block Unit. Repeat to make (8) total units. Set leftover Pinwheel Blocks aside for Step 9.

Make (8)

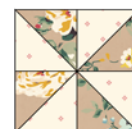
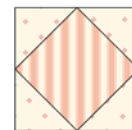
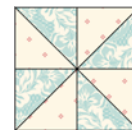

$4\frac{1}{2}" \times 16\frac{1}{2}"$

ROSE GARDEN PANEL QUILT

5. Sew (1) **D**-rectangle to the right side of (1) Panel rectangle as shown below. Next, sew (1) **C**-rectangle to the bottom. In the same manner, sew (1) Block Unit to the right side and (1) Block Unit to the bottom, paying careful attention to orientation of the units, to make (1) Section 1.

Section 1



6. Repeat Step 5 to make Sections 2-4, paying careful attention to the placement and orientation of the rectangles and units.

Section 2



Section 3

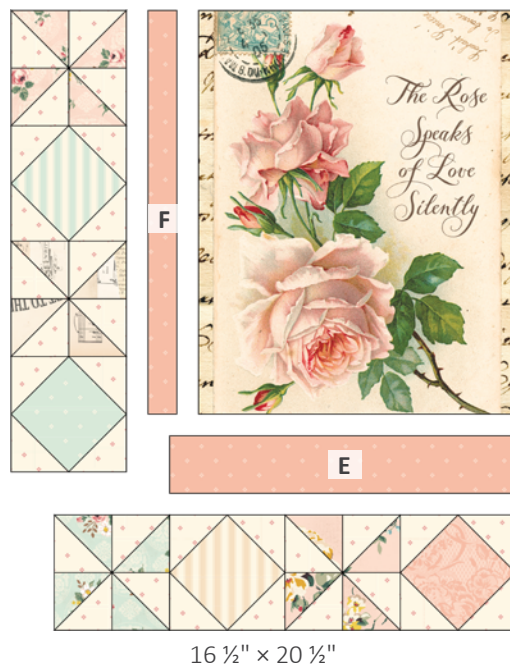

Section 4



ROSE GARDEN PANEL QUILT

7. Sew (2) **I**-rectangles and (1) **G**-rectangle together as shown below to make (1) Short Sashing Unit. Repeat to make (6) total units.

Make (6)



4 ½" × 16 ½"

8. Sew (2) **J**-rectangles and (1) **H**-rectangle together as shown below to make (1) Long Sashing Unit. Repeat to make (6) total units.

Make (6)

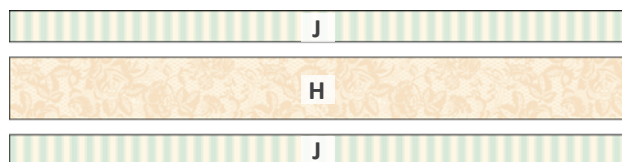

4 ½" × 20 ½"

9. Arrange (9) Pinwheel Blocks, (6) Short Sashing Units, (6) Long Sashing Units, and Sections 1-4 as shown, top right. Sew the pieces together into rows. Next, sew the rows together to complete the quilt top.

QUILT LAYOUT DIAGRAM



44 ½" × 52 ½"

FINISHING INSTRUCTIONS

10. Layer the quilt top, batting, and backing. Baste the quilt layers together and quilt as desired. Sew the Blue Dots binding strips together end-to-end. Then bind the trimmed, finished quilt using your favorite binding method.

Enjoy and share your quilt using the hashtags:

[#bouquetdesfleursfabric](#), [#rosegardenpanelquilt](#), [#rileyblakedesigns](#), and [#iloverileyblake](#).