

THIS WAY

Riley Blake
DESIGNS™



49 1/2" x 55 1/2"



= Confident Beginner

THOMAS & FRIENDS x Tsumi eede

07/01/2024

THIS WAY

FINISHED QUILT SIZE 49 ½" × 55 ½"

Please read all instructions before beginning this project.
Yardage calculated using a 42" usable width of fabric.

GENERAL INSTRUCTIONS

Please check www.rileyblakedesigns.com/pattern-updates for any revisions before starting this project. This pattern requires a basic knowledge of quilting techniques and terminology. The quilt and block diagrams portrayed are virtual images. The layout and look of your project may differ when using actual fabric. It is not recommended to prewash fabric before cutting and assembling.

Always verify your panel size before beginning. If your panel measurements differ from those given in the pattern, trim to the desired size or use coping strips to alter the size of your panel. If coping strips are needed, add oversized, coordinating strips of fabric to the necessary edges of the panel, then trim to the size specified in the pattern.

WOF = Width of Fabric
RST = Right Sides Together
HST = Half Square Triangle

FABRIC REQUIREMENTS

All fabrics from the Thomas & Friends™ Sodor Railway collection unless stated otherwise.

- (1) 5-15080-42 5-Inch Stacker
- ¾ yard C15085-MULTI Thomas & Friends™ Cheater Print
- ¾ yard C120-CLOUD Confetti Cottons Solid
- ⅞ yard C15080-CHARCOAL Main
- 1 yard C15083-BLUE Round the Track (includes binding)

OTHER SUPPLIES

- Basic Sewing Supplies
- 1 ⅞ yards Wide Back backing fabric of your choice
(suggested WB200-CHAMBRAY Shades)
- Batting

CUTTING INSTRUCTIONS

When cutting fabrics, use a straight edge ruler and rotary cutter. Measurements include ¼" seam allowance. Label, allocate, and organize all cuts as noted.

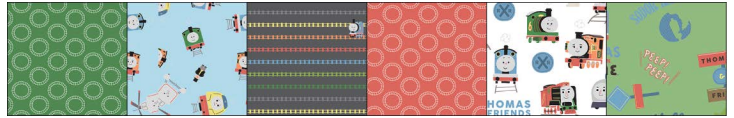

5-Inch Stacker

Select (14) pairs of matching squares. Label as A.

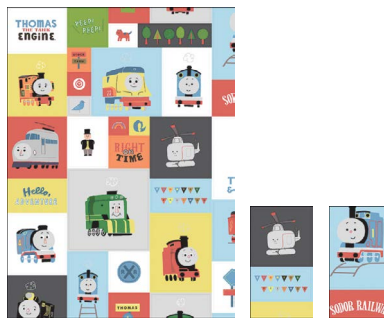

Multi Thomas & Friends™ Cheater Print

Fussy cut (1) 17" × 23" rectangle, centered over the motifs shown or over your preferred motifs. Label as B.
Fussy cut (2) 5" × 8 ½" rectangles, centered over the motifs shown or over your preferred motifs. Label as C.



Cloud Confetti Cottons Solid

Cut (4) 5" × WOF strips; subcut:
(28) 5" × 5" squares. Label as D.
(2) 3" × 8 ½" rectangles. Label as E.



Charcoal Main

Cut (5) 4 ¾" × WOF strips. Piece together end-to-end; subcut:
(2) 4 ¾" × 49 ½" strips. Label as F for outer top/bottom borders.
(2) 4 ¾" × 47" strips. Label as G for outer side borders.

THIS WAY



Blue Round the Track

Cut (12) 2 ½" × WOF strips.

Set (6) strips aside for binding.

Piece the remaining strips together end-to-end; subcut:

(2) 2 ½" × 43" strips. Label as H for middle side borders.

(2) 2 ½" × 41" strips. Label as I for middle top/bottom borders.

(2) 2 ½" × 23" strips. Label as J for inner side borders.

(2) 2 ½" × 21" strips. Label as K for inner top/bottom border.

Note: For directional fabrics in this pattern, make sure the print is aligned in the same direction for each set of print and background squares. Create (2) HSTs by drawing the diagonal from bottom left to top right. Create (2) additional HSTs by drawing the diagonal from top right to bottom left.

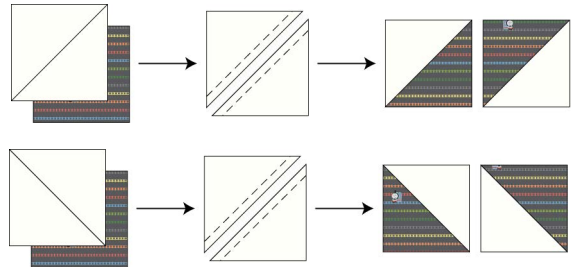

SEWING TECHNIQUES

Sew all seams RST and with a ¼" seam allowance unless stated otherwise. Refer to the quilt layout diagram for placement of the prints. Press seams as desired unless stated otherwise. Dimensions listed in steps are unfinished sizes. Please refer to the following general sewing technique as this method is referenced throughout the pattern in its abbreviated form.

2-AT-A-TIME HALF SQUARE TRIANGLE METHOD (HST)

Place (2) squares RST. Draw a diagonal line on the wrong side of (1) square. Stitch ¼" on each side of the drawn line. Cut on the drawn line to create (2) HSTs. Press toward the darker fabric. Trim HSTs to desired size.

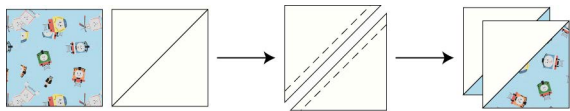

BLOCK ASSEMBLY

1. Gather (1) matching pair of **A**-squares and (2) **D**-squares. Use the HST method to make (4) matching HST units. Trim each HST unit to 4 ½" × 4 ½".

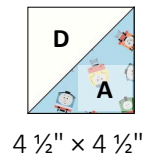

2. Arrange and sew the (4) matching HST units as shown to make (1) block that measures 8 ½" × 8 ½".

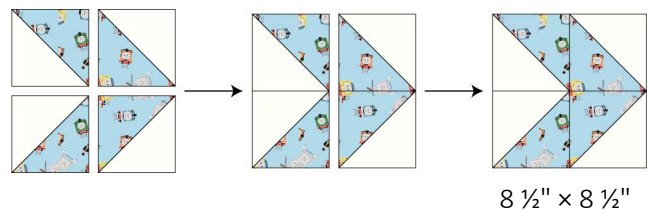

3. Repeat steps 1-2 to make (14) total blocks.

THIS WAY

QUILT ASSEMBLY

4. Arrange the blocks and pieces as shown. Sew the blocks and **E**-rectangles together to create the pieced side borders. Next, sew the blocks and **C**-rectangles together to make the pieced top/bottom borders.
5. Sew the **J**-inner side borders to the **B**-rectangle. Next, add the **K**-inner top/bottom borders.
6. Add the pieced side borders, followed by the pieced top/bottom borders. The quilt center should measure 37" x 43".

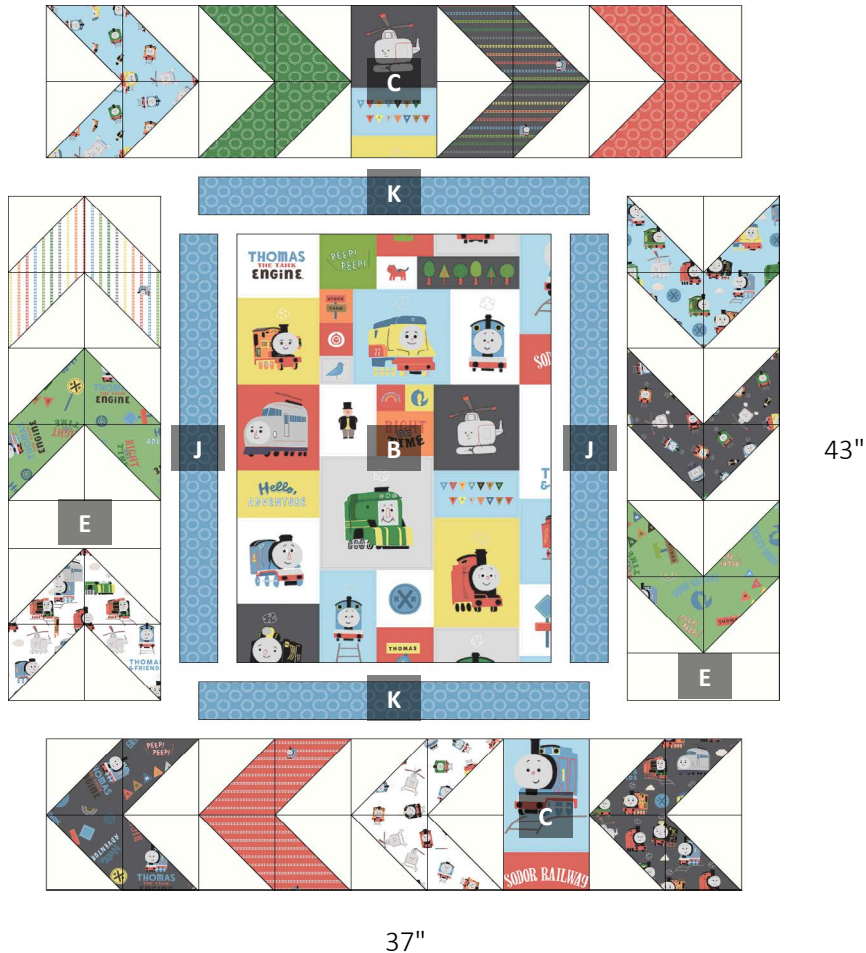

7. Arrange the quilt center, middle borders, and outer borders as shown in the quilt layout diagram on page 5. Sew the **H**-middle side borders to the quilt center, followed by the **I**-middle top/bottom borders.
8. Add the **G**-outer side borders, followed by the **F**-outer top/bottom borders. The quilt top should measure 49 1/2" x 55 1/2".
9. Finish your quilt by layering the quilt top, batting, and backing. Baste the quilt layers together and quilt as desired. Sew the Blue Round the Track binding strips together end-to-end. Then bind the trimmed, finished quilt using your favorite binding method.

Enjoy and share your quilt using the hashtags [#thomasandfriendsodorrailwayfabric](#), [#thiswayquilt](#), [#rileyblakedesigns](#), and [#iloverileyblake](#).

THIS WAY

QUILT LAYOUT DIAGRAM



49 1/2" x 55 1/2"

CREATED BY BRITT ALLCROFT

Based on the Railway Series by The Reverend W Awdry. ©2022 Gullane (Thomas) Limited. Thomas the Tank Engine & Friends™ and Thomas & Friends™ are trademarks of Gullane (Thomas) Limited.



©2024 HIT Entertainment Limited. HIT and the HIT logo are trademarks of HIT Entertainment Limited.