

Day 4: 12 Days of Christmas with RBD

12" x 12" Finished

rileyblakedesigns.com @rileyblakedesigns

FABRIC REQUIREMENTS

C780-TREETOP (*Fabric 1*)

C120-CLOVER (*Fabric 2*)

C120-SAGE (*Fabric 3*)

CUTTING INSTRUCTIONS

Fabric 1:

- A – (5) 5" x 5" squares

Fabric 2:

- B – (5) 5" x 5" squares

Fabric 3:

- C – (8) 3 ½" x 3 ½" squares
- D – (2) 2" x 5" rectangles
- E – (2) 2" x 3 ½" rectangles
- F – (1) 1 ½" x 12 ½" rectangle
- G – (1) 1" x 12 ½" rectangle

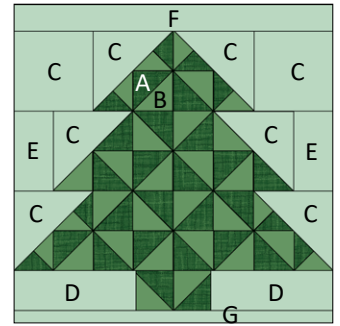

RST = RIGHT SIDES TOGETHER

HST = HALF SQUARE TRIANGLE

SNF = STITCH AND FLIP

Sew all seams RST and with a ¼" seam allowance. Press seams as desired unless stated otherwise. Dimensions listed in steps are unfinished sizes. Refer to the following general sewing techniques as these methods are referenced throughout the pattern in their abbreviated form.

STITCH AND FLIP METHOD INSTRUCTIONS (SNF)

Place (2) pieces RST, matching raw edges in the corner to be replaced. Draw a diagonal line on the wrong side of the smaller piece across the corner. Sew on the drawn line. Trim the seam allowance outside the sewn line to ¼". Flip the smaller piece away from the larger piece and press, replacing the corner. The size of the larger, original piece does not change.

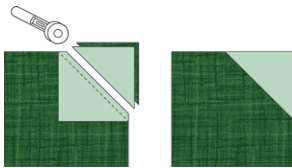

8-AT-A-TIME HALF SQUARE TRIANGLE METHOD

INSTRUCTIONS (HST)

Place (2) squares RST. Draw a diagonal line in both directions on the wrong side of (1) square. Sew ¼" on each side of both drawn lines. Cut on the drawn lines and through the vertical and horizontal center to create (8) HSTs. Press toward the darker fabric. Trim HSTs to the indicated size.

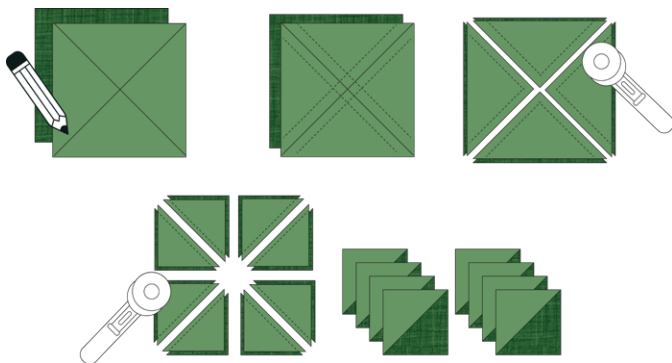

SEWING INSTRUCTIONS

1. Gather the required pieces and use the 8-at-a-time HST method to make the unit shown below, referencing the diagram for quantity, proper placement, and orientation. Trim each unit to the size indicated.

Make (40)



2" x 2"

2. Sew (2) HST units together as shown below, paying careful attention to the orientation of the units, to make (1) HST Pair Unit. Repeat to make (19) total units. Note: You will have leftover HST units.

Make (19)



2" x 3 ½"

3. Sew (4) HST Pair Units together as shown below, paying careful attention to the orientation of the units. Next, use the SNF method to sew (1) C-square to each top corner to make (1) Tree Top Unit.

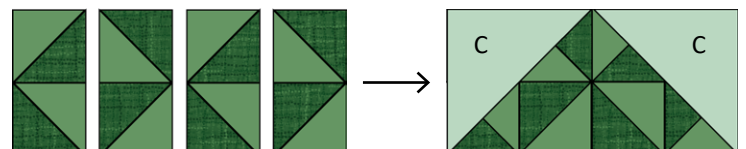

3 ½" x 6 ½"

Day 4: 12 Days of Christmas with RBD

12" x 12" Finished

rileyblakedesigns.com @rileyblakedesigns

4. Sew (6) HST Pair Units together as shown below, paying careful attention to the orientation of the units. Next, use the SNF method to sew (1) **C**-square to each top corner to make (1) Tree Center Unit.

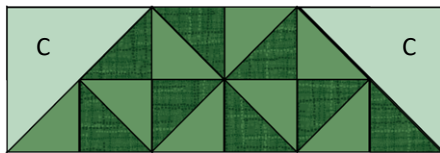
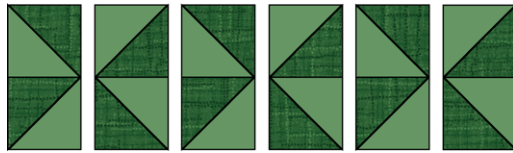

3 1/2" x 9 1/2"

5. Sew (8) HST Pair Units together as shown below, paying careful attention to the orientation of the units. Next, use the SNF method to sew (1) **C**-square to each top corner to make (1) Tree Bottom Unit.

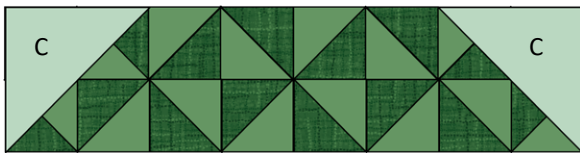
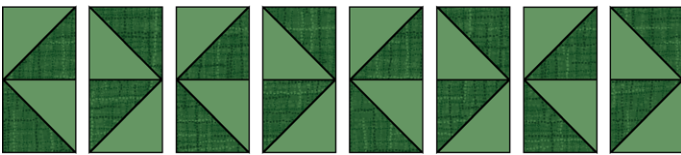

3 1/2" x 12 1/2"

6. Arrange (1) **F**-rectangle, (2) **C**-squares, (1) Tree Top Unit, (2) **E**-rectangles, (1) Tree Center Unit, (1) Tree Bottom Unit, (2) **D**-rectangles, (1) HST Pair Unit, and (1) **G**-rectangle as shown below, paying careful attention to the orientation of the units. Sew the pieces and units together into rows. Next, sew the rows together to make the Day 4 block. The block should measure 12 1/2" x 12 1/2" unfinished.

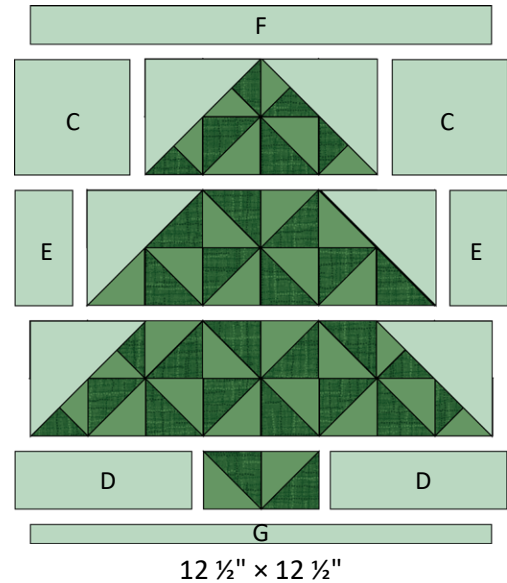

Your block is complete!

