

Block 11: Pinwheel Pop

by Amanda Niederhauser

10" x 10" Finished

jediraftgirl.com @jediraftgirl

CONFETTI COTTON SOLIDS

BY RILEY BLAKE DESIGNS

C120-GOLDEN

(Fabric 1)

C120-SHORTBREAD

(Fabric 2)

C120-STORM

(Fabric 3)

C120-WHITESAND

(Fabric 4)

C120-COLONIAL

(Fabric 5)

EXPRESSIONS HAND-DYES

BY RILEY BLAKE DESIGNS

BT21000-532 SANDSTONE

(Fabric 1)

BT21000-345 MELLO

YELLOW (Fabric 2)

BT21000-153 HARBOR

GRAY (Fabric 3)

BT21000-112-15 CREAM

(Fabric 4)

BT21000-304 SLATE

(Fabric 5)

CUTTING INSTRUCTIONS

Fabric 1:

- A – (8) 2 ½" x 2 ½" squares

Fabric 2:

- B – (8) 2 ½" x 3 ½" rectangles

Fabric 3:

- C – (4) 2 ½" x 2 ½" squares
- D – (8) 1 ½" x 1 ½" squares

Fabric 4:

- E – (2) 4" x 4" squares

Fabric 5:

- F – (2) 4" x 4" squares

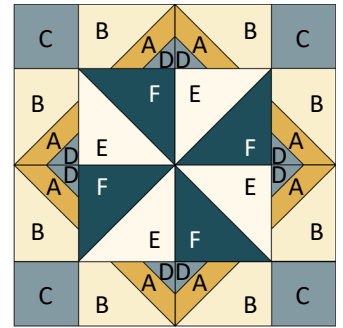

ADDITIONAL RECOMMENDED TOOLS:

3 ½", 10 ½" TRIM-IT™ RULERS

RILEY BLAKE DESIGNS QUILTY

TOOLS™ ¼ INCH PLUS RULER

LORI HOLT SEW HANDY STICKERS

RILEY BLAKE DESIGNS QUILTER'S

CLAPPER

SUE DALEY DESIGNS ROTATING

CUTTING MAT

SEAMS SEW EASY™ SEAM GUIDE

RST = RIGHT SIDES TOGETHER

HST = HALF SQUARE TRIANGLE

Sew all seams RST and with a ¼" seam allowance. Press seams as desired unless stated otherwise. Dimensions listed in steps are unfinished sizes.

SEWING INSTRUCTIONS

1. Draw a diagonal line on the wrong side of (8) **A**-squares, (8) **D**-squares, and (2) **E**-squares.
2. Align (1) marked **A**-square with the bottom-right corner of (1) **B**-rectangle, RST. Sew on the drawn diagonal line. Trim excess corner fabric to ¼". Press toward the corner. Next, align (1) marked **D**-square with the **A**-corner of the same unit, RST. Sew, trim, and press as before to make (1) Left Unit. Repeat to make (4) total units.

Make (4)

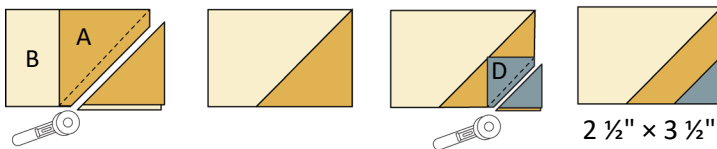

3. Repeat Step 2, aligning marked **A**-squares and marked **D**-squares with the bottom-left corner of **B**-rectangles. Repeat to make (4) total Right Units.

Make (4)

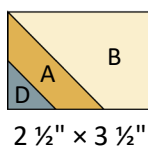

4. Sew (1 Left Unit and (1) Right Unit together as shown below to make (1) Side Unit. Repeat to make (4) total units.

Make (4)

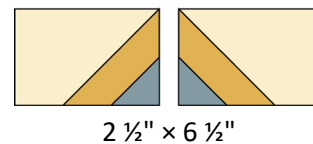

5. Layer (1) marked **E**-square on (1) **F**-square, RST. Sew ¼" on each side of the drawn line. Cut on the drawn line. Press to make (2) HST units. Repeat to make (4) total units. Trim each HST to 3 ½" x 3 ½".

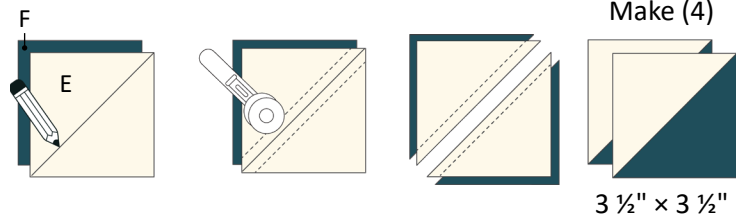

3 ½" x 3 ½"

Block 11: Pinwheel Pop

10" x 10" Finished

by Amanda Niederhauser

jedicraftgirl.com @jedicraftgirl

6. Arrange (4) HST units as shown below. Sew the units together into pairs. Next, sew the pairs together to make (1) Center Unit.

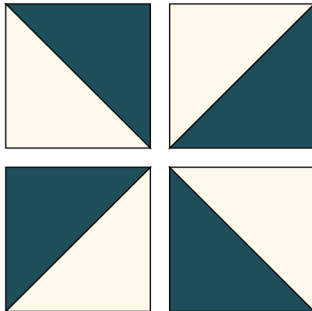

6 1/2" x 6 1/2"

7. Arrange (4) C-squares, (4) Side Units, and (1) Center Unit as shown below. Sew the squares and units together into rows. Next, sew the rows together to make Block 11. Block 11 should measure 10 1/2" x 10 1/2" unfinished.

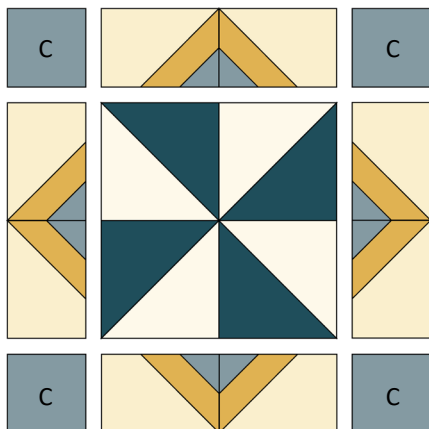

10 1/2" x 10 1/2"

Your block is complete!

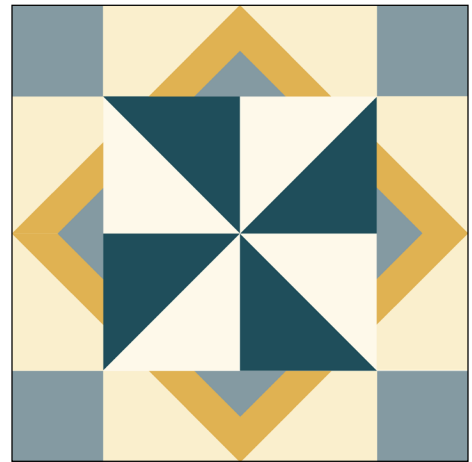

Due to the hand-crafted nature of batiks, fabric may vary from images.