

# Block 12: Majestic View

by Casey Cometti

10" x 10" Finished

wellspringdesignsquilting.com @wellspringdesigns\_co

## CONFETTI COTTON SOLIDS

BY RILEY BLAKE DESIGNS

### C120-ZUCCHINI

(Fabric 1)

### C120-ASPARAGUS

(Fabric 2)

### C120-BEEHIVE

(Fabric 3)

### C120-STORM

(Fabric 4)

## EXPRESSIONS HAND-DYES

BY RILEY BLAKE DESIGNS

### BT21000-315 OLIVE

(Fabric 1)

### BT21000-720 SPRING

MEADOW (Fabric 2)

### BT21000-344 BELLINI

(Fabric 3)

### BT21000-153 HARBOR

GRAY (Fabric 4)

## CUTTING INSTRUCTIONS

### Fabric 1:

- A – (2) 4 ½" x 4 ½" squares
- B – (1) 2 ½" x 4 ½" rectangle
- C – (2) 2 ½" x 2 ½" squares

### Fabric 2:

- D – (2) 4 ½" x 4 ½" squares
- E – (2) 2 ½" x 2 ½" squares

### Fabric 3:

- F – (1) 4" x 4" square

### Fabric 4:

- G – (2) 4 ½" x 4 ½" squares
- H – (1) 2 ½" x 6 ½" rectangle
- I – (3) 2 ½" x 2 ½" squares

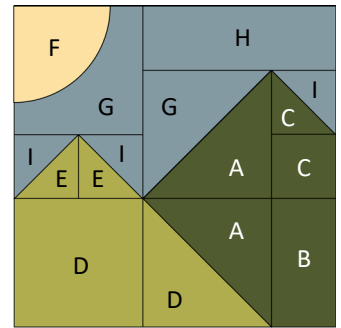

RST = RIGHT SIDES TOGETHER  
HST = HALF SQUARE TRIANGLE

Sew all seams RST and with a ¼" seam allowance. Press seams as desired unless stated otherwise. Dimensions listed in steps are unfinished sizes.

## ADDITIONAL RECOMMENDED TOOLS:

LIGHTWEIGHT FUSIBLE WEB

2 ½", 4 ½", 10 ½" TRIM-IT™ RULERS

RILEY BLAKE DESIGNS QUILTY

TOOLS™ ¼ INCH PLUS RULER

LORI HOLT SEW HANDY STICKERS

RILEY BLAKE DESIGNS QUILTER'S  
CLAPPER

SUE DALEY DESIGNS ROTATING

CUTTING MAT

SEAMS SEW EASY™ SEAM GUIDE

## SEWING INSTRUCTIONS

1. Draw a diagonal line on the wrong side of (2) **A**-squares and (3) **I**-squares.
2. Layer (1) marked **I**-square on (1) **E**-square, RST. Sew on the drawn diagonal line. Trim excess corner fabric to ¼". Press toward the corner to make (1) E/I HST unit. Repeat to make a second unit.

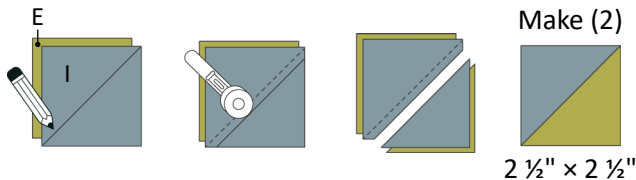

3. Repeat Step 2 to make (1) of each HST unit shown below.

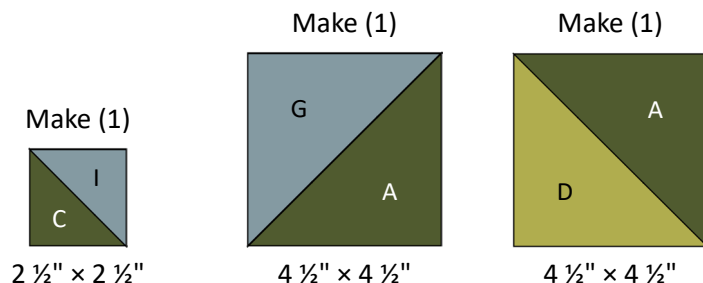

4. Sew (2) E/I HST units together as shown below to make (1) Small Mountain Top Unit.

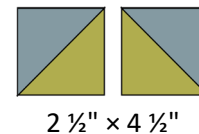

5. Sew (1) C/I HST unit and (1) **C**-square together as shown below. Next, sew (1) A/G HST unit to the left side to make (1) Large Mountain Top Unit.

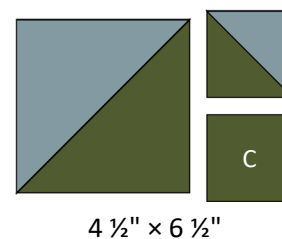

6. Sew (1) A/D HST unit and (1) **B**-rectangle together as shown below to make (1) Large Mountain Bottom Unit.

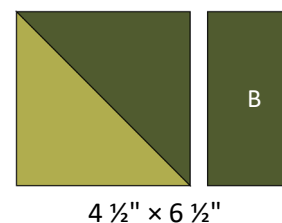

# Block 12: Majestic View

10" x 10" Finished

by Casey Cometti

wellspringdesignsquilting.com @wellspringdesigns\_co

7. Arrange (1) **G**-square, (1) Small Mountain Top Unit, (1) **D**-square, (1) **H**-rectangle, (1) Large Mountain Top Unit, and (1) Large Mountain Bottom Unit as shown below. Sew the pieces together into columns. Next, sew the columns together to make Block 12. Block 12 should measure 10 ½" x 10 ½" unfinished.

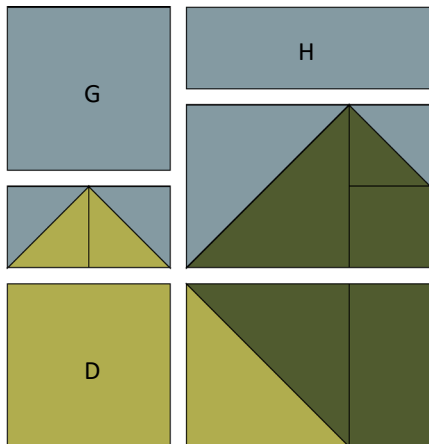

10 ½" x 10 ½"

## APPLIQUÉ INSTRUCTIONS

8. Instructions are provided for raw edge fusible appliqué. To prepare and cut the appliqué piece, place the Moon Template right side up on a light table or window. Trace the shape onto the paper side of the fusible web, leaving at least ¼" of space around the traced shape. Roughly cut outside the drawn line of the shape, leaving at least ¼" of fusible web. Fuse the traced shape to the **WRONG** side of the **F**-square following the manufacturer's instructions. Once cool, cut out the shape exactly on the drawn line.

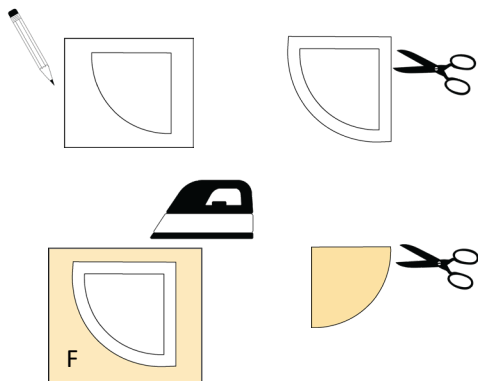

9. Remove the paper backing from the Moon shape. Arrange the Moon shape in the top-left corner of the block. Refer to the diagram, right, for placement. Fuse the appliqué shape in place following the manufacturer's instructions. Once cool, stitch around the edge of the appliqué shape using a straight or small zigzag stitch in your choice of thread.

Template is actual size. Template is already reversed for ease of use for the raw-edge fusible appliqué method. Seam allowances are not included on the template; add them if using another appliqué technique.

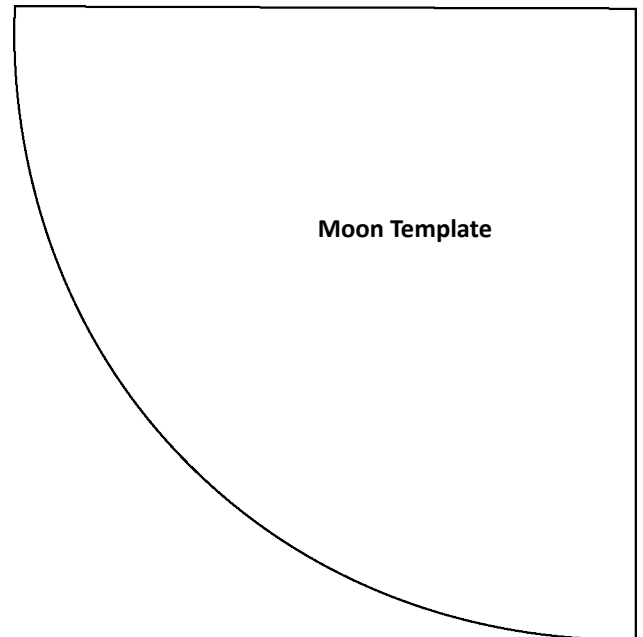

Print at 100%.  
This square  
should  
measure 1".

*Your block is complete!*

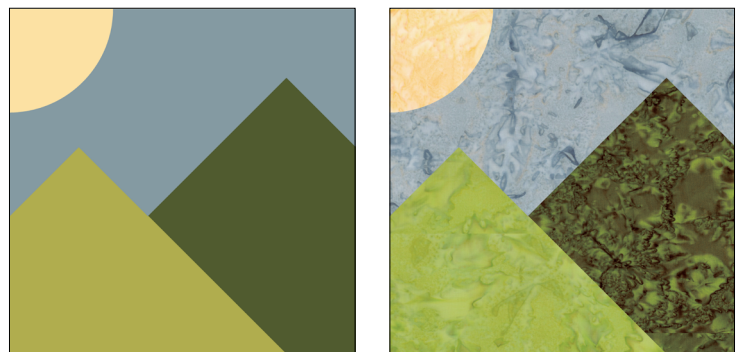

*Due to the hand-crafted nature of batiks, fabric may vary from images.*